

REPLACEMENT PARTS LIST

Table of Contents

OMNI-EYE I CAMERA PARTS ONLY	3
OMNI EYE II & OMNI-EYE III SERIES CAMERA PARTS	3
SKIDS & RAILS	3
SCREWS, O-RINGS & KITS, OEIIZ & OEIIIIZ SERIES CAMERAS	4
LAMPS.....	4
WINDOW KITS - OMNI-EYE IIZ & IIIZ & INVESTIGATOR CAMERA.....	4
OMNI STAR COLOR LED CAMERA	4
NOVA STAR COLOR LED CAMERA.....	4
CABLES, CONNECTORS & PIGTAILS	4
3-PIN PUSH ON STYLE PIGTAIL.....	4
CABLES & CONNECTORS – TWIST-ON BULLET STYLE	5
BULKHEAD CONNECTORS	5
BULLET-STYLE REMOVABLE PIGTAIL KIT & REPLACEMENT PARTS.....	5
MINI CAMERA REPLACEMENT PARTS.....	6
SKID KITS AND REPLACEMENT PARTS	6
SKID SLEEVES.....	6
WINDOWS, LENS LAMPS, AND LAMP KITS	6
MINI CAMERA TAIL ASSEMBLIES	6
CABLES & CONNECTORS	6
MISC PARTS & KITS – MINI CAMERAS.....	7
CONTROLLERS PARTS AND ACCESSORIES	7
DESKTOP AUXILIARY CONTROLLER REPLACEMENT PARTS	7
DIAMOND PLATE/BOX CONTROLLER PARTS 1300.....	7
MAINLINE CONTROLLER PARTS.....	7
TRANSPORTER REPLACEMENT PARTS & ACCESSORIES	7
TREAD DRIVE OPTION ASSEMBLY & REPLACEMENT PARTS	7
STANDARD TRANSPORTER AXLE EXTENSIONS.....	8
ADHESIVES FOR INSTALLING TIRES ONTO BRASS WHEELS	8
STANDARD TRANSPORTER TIRES, WHEELS, & ACCESSORIES.....	8
STANDARD TRANSPORTER BODY SKID RAILS	8
STANDARD TRANSPORTER MOTOR PARTS.....	8
STANDARD TRANSPORTER BODY PARTS - AXLE/GEAR ASSEMBLIES AND PARTS.....	9
MISC. PARTS, HARDWARE KITS, GREASE, GASKETS, ETC.....	9
STANDARD TRANSPORTER CRADLE ASSEMBLIES & REPLACEMENT PARTS.....	9
CAMERA CRADLES	10
6" & 8" CRAWLER MOTOR / GEARBOX REPLACEMENT PARTS	10
6" CRAWLER TRACK DRIVE REPLACEMENT PARTS.....	10
8" CRAWLER TRACK DRIVE REPLACEMENT PARTS.....	10

STEERABLE STORM DRAIN (LARGE LINE) TRACTOR PARTS.....	11
LARGE LINE LIGHTS PARTS & ACCESSORIES	11
CABLE	11
3-PIN FEMALE PUSH-ON, TERMINATED.....	11
3-PIN (BULLET) SCREW-ON W/ 3 CONDUCTOR CONNECTOR.....	11
EXPLOSION PROOF TERMINATED	11
PUSH CABLE ASSEMBLIES, TERMINATED	11
AIRCRAFT CABLE, PER FOOT	11
IN-LINE SONDE TRANSMITTERS.....	12
CABLE REEL PARTS AND CABLE ASSYS.....	12
COMPACT PORTABLE REEL MECHANICAL REPLACEMENT PARTS.....	12
COMPACT PORTABLE CABLE REEL ELECTRICAL REPLACEMENT PARTS	12
PUSH REEL REPLACEMENT PARTS (STANDARD PUSH REEL, ONLY).....	12
MAINLINE CABLE REEL REPLACEMENT MECHANICAL PARTS	12
MAINLINE CABLE REEL ELECTRICAL PARTS.....	13
REMOTE POWER WINCH II REPLACEMENT PARTS	14
POWER WINCH 1 (REPLACEMENT PARTS ONLY)	14
DOWNHOLE ROLLER REPLACEMENT PARTS	14
ARTICULATING ARM REPLACEMENT PARTS	14
INVESTIGATOR CAMERA SYSTEM.....	14
 EQUIPMENT PICTURES WITH MOST FREQUENTLY ORDERED PART NUMBERS BY PRODUCT.....	 15-35

OMNI-EYE SERIES CAMERA REPLACEMENT PARTS AND ACCESSORIES INCLUDES: OEI, OEII, OEIII, ALL ZOOM CAMERAS, & INVESTIGATOR (a.k.a. PoleCam)

OMNI-EYE I CAMERA PARTS ONLY

*** ITEM ABOVE FOR APPLICATION OF HARDWARE

301-15303	10-32x5/8" FLATHEAD SCREW SS, UC CENTER RAIL (2 REQUIRED)
301-12475	8-32x1/4" FLATHEAD UC SS SCREW (2 REQUIRED)
301-12823	8-32x3/8" FLATHEAD UC SS SCREW (5 REQUIRED)
301-12881	8-32x5/8" FLATHEAD SS SCREW (3 REQUIRED)
301-13172	10-32x3/8" FLATHEAD PHH SCREW SS UC (FOR ABOVE SKID)
301-13572	8-32x3/4" FLATHEAD UC SS SCREW (4 REQUIRED)
305-10241	MSCR, SEALING, PAN, PHH, 10-32X1.25 SS
403-13419	SPACER, CENTER TOP RAIL (2 REQUIRED)
440-11014	BELT, 3-D, 100 TEETH, 15.7"L OEI ONLY
450-14625	TOP CENTER BODY SKID - OMNI EYE I ONLY (HEAD STOP)
450-14683	BODY SKID RAILS FOR OEI
450-15680	BOTTOM HEAD SKID
450-15739	TOP HEAD SKID
549-11931-30	QUARTZ WINDOW FOR OE I AND MAINLINE CAMERA
840-10411	OMNI-EYE I CLUTCH HARDWARE KIT
840-20420	WINDOW KIT FOR OEI / MAINLINE CAMERAS (1) 549-11931-30 QUARTZ WINDOW (1) 439-15856 O-RING, SILICONE #040 (1) 439-15616 O-RING, SILICONE, 024 (6) 301-11358 MSCR, PANHEAD, 4-40x5/8", SS, 6 EA
841-12004	10 PACK #791, 35W, (RCA version, MAINLINE/OEI)

OMNI EYE II & OMNI-EYE III SERIES CAMERA PARTS SKIDS & RAILS

301-13515	8-32x1/2" FLATHEAD UC SS SCREW (4 REQUIRED)
301-13742	8-32 x .25" FLATHEAD SCREW, UNDERCUT
301-14203	8-32X .625" PANHEAD SCREW (4 REQUIRED)
403-13419	SPACER FOR MIDDLE BODY RAIL - OEIII
450-10134	SKID RUNNER EXTENSION
450-14159	SKID EXTENSION W/BRIDLE, FOR 6" – 16" ASSY
450-14391	BOTTOM HEAD SKID (APPLICABLE TO OEII / OEIII / OEII Z / OEIII Z / INVESTIGATOR)
450-14449	TOP HEAD SKID – OEII & OEIII SERIES
450-14683	BODY RAIL - OEII & OEIII (3 REQUIRED)
450-20329	TOP BODY SKID (REQUIRES SKID BRACKETS FOR INSTALLATION) (OEIII BODY SKID, TO SKID BRACKETS)
451-20335	TOP BODY SKID BRACKETS (2 REQUIRED)
800-17767	CRADLE, CAMERA, OEII
800-21075	CRADLE, CAMERA, OEIII
807-17784	SKID ASSY, ADJUSTABLE, 6"-16"
807-30408	SKID ASSY, INCLINOMETER, 6", OEII ONLY
807-14797	SKID SET, 5"
840-20504	BOLT, PINCH, KIT (INCLUDES PINCHBOLT & NYLOCK NUT)

SCREWS, O-RINGS & KITS, OEIIZ & OEIIIZ SERIES CAMERAS

439-15321 O-RING, SILICONE, #023 (OEII/III LENS)
439-15557 O-RING, SILICONE, #022 (OEII/III LIGHT REFLECTOR HOUSINGS)
(2 REQUIRED)
701-12230 CASE, CARRYING, CAMERA
840-15131 KIT, HARDWARE, OMNI II CAMERA
840-19920 MAINTENANCE KIT (OEIII)
840-15485 MAINTENANCE KIT (OEII)
840-11060 KIT, O-RING (OEII & OE III)

LAMPS

541-10326 LAMP, HALOGEN, 14V, 25W, #790
(PULNIX OEI & MAINLINE, OEII/OEIII)
541-10385 LAMP, HALOGEN, 14V, 25W, #791 (OEI ONLY)
541-21295 LAMP, HALOGEN, 12V, 20W: OEIIZ & OEIIIZ NON-LISTED
541-30962 LAMP, HALOGEN, 12V, 20W: OEIIZ & OEIIIZ LISTED ONLY
841-12063 10 PACK, #790, 25W
(PULNIX OEI & MAINLINE, OEII/OEIII)
841-31900 10 PACK, ONLY, 12V, 20W: OEIIZ & OEIIIZ ONLY

WINDOW KITS - OMNI-EYE IIZ & IIIZ & INVESTIGATOR CAMERA

301-11181 4-40 X .31 PANHEAD SCREW (RETAINER WINDOW SCREWS)
451-10195 RETAINER WINDOW
840-13442 WINDOW KIT TO INCLUDE:
(1) 549-17208 WINDOW, SAPHIRE
(1) 317-17066 WASHER, FLT, TEFLON
(1) 970-17226 PROCEDURE, INSTALLATION

OMNI STAR COLOR LED CAMERA

840-34471 SCREW KIT, TO INCLUDE:
(9) EA 301-10532, MSCR, FLT, PHH, 4-40 X.25, SS
(8) EA 301-12475, MSCR, FLT, PHH, 8-32 X .25, UNDERCUT, SS
(6) EA 301-13172, MSCR, FLT PHH, 10-32 X .37, UNDERCUT, SS
450-33609-42 SKID, CAMERA HEAD TOP SKID
450-33612-42 SKID, CAMERA HEAD BOTTOM SKID
450-33655 CAMERA BODY TOP RAILS (REQUIRES 2)

NOVA STAR COLOR LED CAMERA

450-20329 TOP BODY SKID (REQUIRES SKID BRACKETS FOR INSTALLATION)
(NOVA STAR & OEIII BODY SKID, TO SKID BRACKETS)
451-20335 TOP BODY SKID BRACKETS (2 REQUIRED)
800-21075 CRADLE, CAMERA, NOVA STAR & OEIIIZ
840-32306 SKID ASSY, ADJUSTABLE, 6"-16"

CABLES, CONNECTORS & PIGTAILS

3-PIN PUSH ON STYLE PIGTAIL

557-13260 PIGTAIL, FEMALE, 3-PIN PUSH ON STYLE, WATER RESISTANT
(MUST BE SOLDERED ON)
560-14003 PLUG, DUMMY FOR 3-PIN FEMALE PIGTAIL
560-15227 PROTECTOR SLEEVE, 3-PIN BULKHEAD CONN. (THREADED)
634-17225 TOOL, PIG TAIL REMOVAL

806-10527 ASSY, CBL, 3-PIN FEMALE PUSH TO TNC (TRACTOR TOP CABLE)
 806-17063 ASSY, CABLE, TEST, 3-PIN FEMALE PUSH -ON / N-PLUG
 806-32662 ASSY, CBL, 3-PIN FEMALE PUSH TO 4 PIN EUROFAST
 (TRANSPORTER TOP CABLE FOR LISTED TRACTOR)

CABLES & CONNECTORS – TWIST-ON BULLET STYLE

557-19528 PIGTAIL, 6-PIN FEMALE SCREW -ON STYLE
 806-19576 ASSY, CBL 3-PIN MALE PUSH-ON TO 6-PIN FEMALE SCREW-ON
 806-19668 ASSY, CABLE, 6-PIN TO TNC, 31: MLT (**TRACTOR TOP CABLE**)
 806-21760 3-PIN (M) SCREW STYLE CONNECTOR to 3-PIN PUSH ON STYLE
 806-30399 ASSY, CABLE, 6-PIN CAMERA TO TNC, S/C CRAWLER, 22-1/2
 CRAWLER TOP CABLE FOR NON-LISTED CRAWLERS)
 806-30631 3-PIN (M) SCREW STYLE to 6-PIN (F) SCREW STYLE
(INTERCONNECT CABLE, TRACTOR TO REEL)
 806-31484 ASSY, CABLE, TEST/ADAPTER CABLE, M/L REEL to CAMERA
 (6-PIN (F) SCREW STYLE TO Np)
 806-32501 ASSY, CBL, 1300 TO TRAC (TNCj/6-PINm) W/ FILTER
 806-34469-12 ASSY, CABLE, 6SKT (IP67) TO 4-PIN EUROFASE, 12 IN
 (TRACTOR TOP CABLE FOR TranSTARS)
 806-34469-21 ASSY, CABLE, 6SKT (IP67) TO 4-PIN EUROFASE, 21 IN
 (CRAWLER TOP CABLE FOR LISTED CRAWLERS)
 806-34469-33 ASSY, CBL, 6-PIN FEMALE SCREW TO 4 PIN 33", EUROFAST
 (TRANSPORTER TOP CABLE FOR LISTED TRACTORS)

BULKHEAD CONNECTORS

557-30633 3-PIN, UNMODIFIED (OLD PART # 557-12796)
 557-32200 6-PIN MALE, THREADED BULKHEAD CONNECTOR, BARE
 806-11000 3-PIN PUSH-ON, PREWIRED (**FOR CAMERA ONLY**)
 806-19679 6-PIN SCREW TYPE, PREWIRED (**OEIII CAMERA NON-LISTED**)
 806-21194 3-PIN PUSH-ON, PREWIRED (**FOR TRACTOR ONLY**)
 806-31431 6-PIN SCREW TYPE, PREWIRED (**ML/OE/OEII CAMERA ONLY**)
 806-31465 6-PIN SCREW TYPE, PREWIRED (**FOR TRACTOR ONLY**)
 806-32514 6-PIN SCREW TYPE, PREWIRED (**OEII LISTED CAMERA**)
 806-33654 6-PIN SCREW TYPE, PREWIRED (**OE STAR CAMERA**)
 806-32688 6-PIN SCREW TYPE, PREWIRED (**OEIII CAMERA LISTED ONLY**)

BULLET-STYLE REMOVABLE PIGTAIL KIT & REPLACEMENT PARTS

807-31639 PROTECTOR SKID, DELRIN, BULLET CONNECTOR
 841-21759 KIT, PIGTAIL, BULLET CONNECTOR 3-PIN SCREW ON, 6-PIN
 PUSH ON STYLE
 841-31486 KIT, INSTALL, FIELD REMOVABLE PIGTAIL, 6-PIN FEMALE
 TO 3-PIN MALE, THREADED CONNECTORS TO INCLUDE:
 (1) 867-31751 ASSY, BULLETT TERMINAL, REMOVABLE PIGTAIL
 SINGLE CONDUCTOR BULLET
 (1) 807-31639 BULLET PROTECTOR DELRIN SLEEVE
 (1) 806-30631 ASSY, CBL, 3-PIN MALE / 6-PIN FEMALE, .4M LONG
 (1) 970-30904 INSTALL. INSTRUCTION MANUAL
 (1) 968-30426 BULLET ASSY. DRAWING
 (1) 634-10347 1/16" ALLEN WRENCH
 841-31910 KIT, CHANGEOVER 6-PIN CONN, TRACTOR, BULLET
 TO INCLUDE:
 (1) 841-31486 Kit install, field removable pigtail 6-p fem – 3-pin m
 (1) 806-31465 Assy, Harness, BHC 6-Pin (M) to Screw-On, MLT
 (1) 806-30631 Assy, Cable, 3-Pin (M)/6-Pin (F), .4M Long

867-31751 REMOVABLE PIGTAIL SINGLE CONDUCTOR TERMINATION BULLET
841-31914 BULLET RETERMINATION KIT, BULLET TO CABLE

MINI CAMERA REPLACEMENT PARTS

SKID KITS AND REPLACEMENT PARTS

305-13745 BODY MOUNTING SCREW, 4-40 X. 188L,SS (1202/1302/1306)
807-13300 KIT, SKIDS, 4" -10" 1201/1202 & 1301/02/06 SERIES CAMS
(INCLUDES BRONZE GUIDES & EXTENSIONS)
807-19075 KIT, SKIDS, 4" – 8" 1207/230 & 1307/1402 SERIES CAMERAS
(INCLUDES BRONZE GUIDES & EXTENSIONS)
840-15503 EXTENSIONS, MINI CAMERA SLEEVES, QTY 18, 1" EXTENSIONS
807-17113 EXTENSIONS, 1", EACH
450-13414 LARGE PHOSPHOR-BRONZE SKID (4 HOLE), EACH
840-14258 LARGE PHOSPHOR-BRONZE SKID KIT, (4-HOLE),
3 PER PKG W/SCREWS
450-13357 SMALL PHOSPHOR-BRONZE SKID (2 HOLE), EACH
840-14200 KIT, SMALL PHOSPHOR-BRONZE SKIDS (2 HOLE),
3 PER PKG W/SCREWS
840-32500 ADAPTER KIT, 1300 CAMERA TO 6-PIN SCREW-ON FOR
MOUNTING TO MAINLINE TRANSPORTER OR SKIDS
(OEII CRADLE, ONLY)

SKID SLEEVES

450-13813-21 ANODIZED ALUMINUM CAMERA SLEEVE FOR 1200 & 1300 SERIES
450-32404-21 ANODIZED ALUMINUM CAMERA SLEEVE FOR 123X & 153X
450-15031 PLASTIC PROTECTIVE SLEEVE FOR 1200 & 1300 SERIES
450-15090 PLASTIC PROTECTIVE SLEEVE FOR 1302 ONLY
450-19037 PLASTIC PROTECTIVE SLEEVE FOR 1207 CAMERA
450-19062 PLASTIC PROTECTIVE SLEEVE FOR 1307 CAMERA
450-32405 PLASTIC PROTECTIVE SLEEVE FOR 1230 CAMERA
450-32433 PLASTIC PROTECTIVE SLEEVE FOR 1235/153X CAMERA

WINDOWS, LENS LAMPS, AND LAMP KITS

541-10503 LAMP ONLY #719, XENON QTY 1 (1202/1302/1306)
541-20963 LAMP ONLY T1-1/2, EACH (1207/1307/1306B)
540-20433 LED, White 5MM Dia., 15 Deg, 6400 CMD
(4 Required for 15XX Series Cameras)
540-20434 LED, White, 5MM Dia, 45-Deg 1100 CMD
(4-Required for 15XX Series Cameras)
840-10116 LENS WINDOW KIT (1201/1202/1301/1302/1306)
840-17770 LENS ASSY FOR 1202/1302
841-11945 KIT, LAMP #719 WITH 4 LAMPS (1202, 1302, 1306)

MINI CAMERA TAIL ASSEMBLIES

867-13285 ASSY, TAIL, 1202/1302 CAMERA, TNC CONN.
867-19070 ASSY, TAIL, REMOVABLE, PLUG, PHENOLIC BALLS, TNC
867-21106 ASSY, TAIL, PLUG, MINI TRACTOR, TNC JACK
867-33048 ASSY, TAIL, PLUG, MINI TRACTOR, 4 PIN EUORFAST
867-19067 ASSY, TAIL, PLUG, SPRING, & BALLS, TNC REMOVABLE

CABLES & CONNECTORS

560-16073 ADAPTER CABLE, MINI TRACTOR TO MAINLINE REEL
TNC – 3-Pin Pigtail (Male)
705-14818 TEST CABLE, MINI SYSTEM TO MINI CAMERA, Np to TNCj

806-10409 3-PIN MALE, PUSH ON, - TNCJ, MINI TRACTOR ADAPTER
 806-10527 TRACTOR TOP CABLE ASSY, OEII (3-PIN PIGTAIL TO TNCp)
 806-10586 3-PIN MALE – PUSH-ON BULLET CABLE TO BULLET
 (1300 CAMERAS TO MAINLINE REEL)
 806-10704 INTERCONNECT CABLE, 3-PIN MALE PIGTAIL, N-JACK
 (MAINLINE REEL TO PUSH CABLE REEL ADAPTER)
 806-10822 ADAPTER CABLE, 1300 TO MAINLINE TRACTOR,
 TNCp – 3-PIN TNCj W/FILTER
 806-19576 ASSY, CBL 6-PIN (F) TURCK TO 3-PIN (M) PUSH ON
 806-19668 ASSY, CBL, (TRACTOR TOP CABLE) 6-PIN TO TNC
 806-21296 ASSY, CBL, ADAPTER, 3-PIN (M) TURCK TO Nj, 2FT
 806-32900 ASSY, CBL, ADAPTER, 3-PIN (M) TURCK TO TNCj

MISC PARTS & KITS – MINI CAMERAS

633-12289 FOCUS ADJUSTMENT TOOL (1202/1302/1306)
 840-10706 CAMERA TRACTOR MOUNTING KIT, ADAPTER, 1302/1306
 CAMERA-MAINLINE EQUIPMENT INCLUDES:
 (1) 450-13927-21 TUBE, SLEEVE, ALUM, 15"L, ANODIZED
 (1) 840-19446 ADAPTER TUBE MOUNTING HARDWARE KIT

CONTROLLERS PARTS AND ACCESSORIES

DESKTOP AUXILIARY CONTROLLER REPLACEMENT PARTS

542-13658 MINI TOGGLE SWITCH – IRIS OR FOCUS
 (SPDT MOMENTARY) LEFT & RIGHT SIDES
 542-12037 PUSH BUTTON W/O LABEL
 542-30606 SWITCH, 3-WAY, 5A (ZOOM/NON-ZOOM FUNCTION)
 706-31314 LABEL FOR CONTROLLER BOX
 806-11177 POWER CORD, SHIELDED TWINAX
 806-17873 IRIS or FOCUS TOGGLE SWITCH ASSY (PREWIRED)
 861-18827 ASSY, PCB, DTMF ENCODER (CIRCUIT BOARD ASSY)

DIAMOND PLATE/BOX CONTROLLER PARTS 1300

452-14222 SUN VISOR

MAINLINE CONTROLLER PARTS

861-31809 ASSY, PCB, RIPPLE FILTER, SINGLE FET, NON-LISTED
 861-31811 ASSY, PCB, RIPPLE FILTER, SINGLE FET, LISTED

TRANSPORTER REPLACEMENT PARTS & ACCESSORIES

TREAD DRIVE OPTION ASSEMBLY & REPLACEMENT PARTS

032-02100-00 COMPLETE TREAD DRIVE KIT TO INCLUDE:
 (1) 807-10901 SKIDS WITH BRIDLE
 (1) 634-17242 5/16" ALLEN WRENCH, LONG ARM
 (1) 866-17655 LEFT TREAD DRIVE
 (1) 866-17654 RIGHT TREAD DRIVE
 (4) 800-17116 3.38" SPACER
 (4) 800-17114 1" SPACER
 (4) 800-17115 1.75" SPACER
 (4) 403-11188 TREAD DRIVE TRACTOR BODY SPACER
 (1) 970-18598 INSTALLATION & OPERATIONS MANUAL
 (4) 300-17207 BUTTONHEAD SCREW ½"-13x1.75" L SS
 840-18353 KIT, ACCESSORY, TREAD DRIVE MAINLINE TRANSPORTER
 867-17243 ASSY, CHAIN, TREAD DRIVE, MAILINE TRANSPORTER (1 PER SIDE)

STANDARD TRANSPORTER AXLE EXTENSIONS

407-11484 8" AXLE EXTENSION (SHANK 1" LONG), 6 REQUIRED
407-11366 10" AXLE EXTENSION (SHANK 1.75" LONG), 6 REQUIRED
407-11425 12" AXLE EXTENSION (SHANK 3.5" LONG), 6 REQUIRED

ADHESIVES FOR INSTALLING TIRES ONTO BRASS WHEELS

630-14943 LOCTITE #410, 20 GRAM BOTTLE

STANDARD TRANSPORTER TIRES, WHEELS, & ACCESSORIES

443-15618 TIRES, STANDARD KNOBBY, EACH
443-10603 WHEEL, STANDARD WITH KNOBBY TIRE (ORDER 6 PER), EACH
443-10544 WHEEL, STANDARD, HUB ONLY, BRASS, EACH
443-15559 TIRE, STANDARD KNOBBY STUDDER, EACH
443-15441 WHEEL, STANDARD, WHEEL W/STUDDER TIRES, EACH
443-10190 WHEEL, CASTER, HI TRACTION, 8"-16" APPLICATION, EACH
443-21569 WHEEL, CASTER, HI TRACTION, STUDDER, 8"-16" EACH
443-15831 WHEEL WIRE, SS, M/L TRACTOR (ORDER 6 PER), EACH
867-21714 BALLOON KNOBBY TIRE / WHEEL ASSEMBLY, EACH

STANDARD TRANSPORTER BODY SKID RAILS

301-12707 SCREW, MSCR, FLT, PHH 8-32 X .37 SS (4 REQ FOR SKID BRKT)
301-12243 SCREW, MSCR, FLT. PHH 8-32 X .37, SS (TOP SKID & CBL COVER
450-19092 SKID RAIL, BOTTOM, PROTECTOR RING TYPE (2 REQUIRED)
450-19093 SKID RAIL, TOP, PROTECTOR RING TYPE
451-14432 MTG BRACKET, SKID, BOTTOM (2 REQUIRED)
451-14451 TOP COVER, RAIL, MAINLINE TRACTOR
451-19072 SKID, CABLE COVER, TOP MOTOR
807-21024 BOTTOM SKID SET W/BRIDLE (RING PROTECTOR)
840-21023 KIT, BULKHEAD PROTECTION RING & SKIDS INCLUDES:
(1) TRANSPORTER TOP SKID
(2) TRANSPORTER BOTTOM SKID
(1) TOP MOTOR RAIL
(1) BULKHEAD PROTECTION RING
867-12313 BRIDLE TOW, 18"

STANDARD TRANSPORTER MOTOR PARTS

408-20423 COUPLING, CLUTCH, FEMALE S/S
453-13930-21 TRACTOR BACK PLATE, ANODIZED BARE
555-11154 TNCj BULKHEAD CONNECTOR, CAMERA POWER TO TRACTOR
557-30002 4-PIN EUROFASE (LISTED) BULKHEAD CONNECTOR
557-32200 BULKHEAD CONNECTOR, 6-PIN, ETL LISTED
560-15227 3-PIN BULKHEAD PROTECTOR SLEEVE
602-10512 SCHRADER VALVE FOR PRESSURE TESTING EQUIPMENT
635-17887 TRACTOR MOTOR 90VDC
802-11352 TRACTOR BACK PLATE WITH 3-PIN PREWIRED BHC & TNCj
802-17886 3-PIN TRACTOR BACK ASSY, INCLUDING CIRCUIT BOARDS
802-31479 6-PIN TRACTOR BACK (TNC) ASSY, INCLUDING CIRCUIT BOARDS
802-32505 6-PIN TRACTOR BACK (LISTED) ASSY, INCL. CIRCUIT BOARDS
806-21194 BHC, 3-PIN PUSH ON STYLE, PRE WIRED (**TRACTOR ONLY**)
861-14085 TRACTOR MOTOR POWER SUPPLY CIRCUIT BOARD ASSEMBLY
861-21321 RELAY FILTER CIRCUIT BOARD ASSEMBLY, TYPE "A"
867-20813 ASSY, CLUTCH, REVERSING, M/L TRACTOR
867-14724 ASSY, CLUTCH, M/L TRACTOR

861-33241-2 ASSY, PCB, MPU, DTMF, LOCKED ROTOR, BLT C, PROGRAMMED
 861-32706 ASSY, PCB, PWR SPLY, TYPE C, MLT (LISTED M/L TRACTOR)
 861-31755 ASSY, PCB, RELAY/FILTER, 'A' MOTOR, BLT, ISOLATED SAFETY
 GROUND (LISTED M/L TRACTOR)

**STANDARD TRANSPORTER BODY PARTS - AXLE/GEAR ASSEMBLIES
 AND PARTS**

301-13856 SCREWS, MSCR, FLT, PHH, 10-32 X 1-25, SS
 405-10658 TRACTOR AXLE BUSHINGS .375" I.D.
**NOTE: THESE BUSHINGS MUST BE REAMED WITH A .379-INCH
 REAMER AFTER BEING INSTALLED - ORDER RST PART #633-15420**

400-20021 DOWEL PIN
 407-20405 MAIN DRIVE AXLE ONLY
 407-20407 WHEEL DRIVE AXLE ONLY
 410-13180 SNAP RING, EXT.750
 439-10719 SEAL, TRACTOR AXLE FOR 3/8" DIAMETER AXLE
 453-15447 BOTTOM BASE PLATE, BRASS, M/L TRACTOR
 453-15565 LEFT SIDE PLATE, BRASS, M/L TRACTOR
 453-15624 RIGHT SIDE PLATE, BRASS, M/L TRACTOR
 453-18594 FRONT & CRADLE BRASS MOUNTING BLOCK
 606-13439 MAIN DRIVE BEARING BLOCK (DOES NOT INCLUDE BUSHING)
 633-15420 REAMER, .379" FOR TRACTOR AXLE BUSHING
 805-19449 WHEEL DRIVE AXLE & GEAR ASSEMBLY (INCLUDES PIN & CLIP)
 840-20808 KIT, GEAR, DOUBLE HUB, (INCLUDES PIN & CLIP)
 840-20809 KIT, GEAR, SINGLE HUB (INCLUDES PIN & CLIP)
 840-21285 REBUILD KIT, TRACTOR BODY,
 840-31609 MAIN DRIVE AXLE ASSEMBLY REPLACEMENT KIT

MISC. PARTS, HARDWARE KITS, GREASE, GASKETS, ETC.

400-10656 PIN, MOTOR MOUNTING
 439-10778 GASKET, TRACTOR TOP
 451-15092 GREASE DAM
 453-14164 COVER, GEAR, MAINLINE TRACTOR
 630-12577 GREASE, SEMI-FLUID UTILITY TYPE 3 6 OZ. JAR
 800-15305 MAINLINE TRACTOR STORAGE MOUNT BRACKET
 840-11296 KIT, HARDWARE, M/L TRACTOR
 840-20821 GEAR COVER STANDOFF REPAIR KIT

***WHEN INSTALLING NEW GEARS ON MAIN DRIVE AXLE SHAFT OR REPLACING
 ENTIRE ASSY, THE CENTER BEARING BLOCK IS RE-INSTALLED ON THE SHAFT WITH NO
 BUSHING. THIS REDUCES DRAG ON THE MOTOR, AND A BUSHING IS NOT NECESSARY FOR
 SUPPORT. IT MUST BE RE-INSTALLED TO PLUG THE HOLES IN TRACTOR SIDE PLATES.***

STANDARD TRANSPORTER CRADLE ASSEMBLIES & REPLACEMENT PARTS

305-15315 CRADLE PIVOT BOLTS
 450-17766 SKID RUNNER, TRACTOR CRADLE, 1/2"X1/2", DELRIN, EACH
 451-17765 FORK, CRADLE, SQUARE TUBE, M/L/OE/OEII CAMERA
 453-30321-21 CENTER CRADLE PLATE
 453-10965-21 LEFT SIDE CRADLE PLATE, EACH
 453-14802-21 RIGHT SIDE CRADLE PLATE, EACH
 800-21074 ASSY, CRADLE FORKS, WELDED, OE3/NOVA
 800-33357 ASSY, CRADLE FORK, WELDED, OMNISTAR
 301-18563 MSCR, HEXHD, 1/4-20 x 1.50 (CENTER PLATE "JACK" BOLT)
 309-12653 NUT, HEX, 1/4-20 (CENTER PLATE "JACK" BOLT NUT)

CAMERA CRADLES

800-17767 CAMERA CRADLE ASSY., MAINLINE/OEI/OEII
800-21075 CAMERA CRADLE ASSY., OEIII/NOVASTAR
800-33353 CAMERA CRADLE ASSY., OE STAR
840-18252 OE/OEII CRADLE FORK UPGRADE KIT TO INCLUDE:
(1) STAINLESS FORKS
(2) SKID RUNNERS
(1) HARDWARE

6" & 8" CRAWLER MOTOR / GEARBOX REPLACEMENT PARTS

410-19071-21 PROTECTOR RING
450-30580 BOTTOM MOTOR SKID
450-30507 TOP MOTOR SKID
805-30234 COMPLETE SINGLE CONDUCTOR MOTOR/GEARBOX ASSY,
6-PIN, THREADED, LISTED
806-30399 CRAWLER TOP CABLE TNCp to 6-PIN THREADED CONNECTOR
806-31465 6-PIN THREADED REAR BULKHEAD CONNECTOR PREWIRED
TRACTOR OR CRAWLER
867-34233 TOW BRIDLE 60", .25" EYELETS, 2-PIECE

6" CRAWLER TRACK DRIVE REPLACEMENT PARTS

305-32637 CHAIN TENSION BOLT 6" CRAWLER
311-32638 CHAIN TENSION ADJ NUT
401-12771 POP RIVET .125" DIAMETER / .188" - .250" LENGTH SS
404-16026 SPROCKET BEARING (DRIVE AND IDLER) 1 REQUIRED FOR EACH
405-33032 REAR DRIVE BUSHING
448-32642 CHAIN TENSION STOP ADJ 6" CRAWLER
449-30327 BRIDLE CLAMPS
449-30907 CHAIN GUIDE WITH **LEFT OFFSET**
449-30908 CHAIN GUIDE WITH **RIGHT OFFSET**
**NOTE: (1) LEFT AND (1) RIGHT CHAIN GUIDE ARE REQUIRED
FOR EACH TRACTOR SIDE**
451-15387 CRAWLER PAD FOR 6" CRAWLER (DOUBLE RIVET DESIGN)
805-30763-40 DRIVE SPROCKET # 35 CHAIN 11 TEETH (REAR)
805-33065 IDLER SPROCKET # 35 CHAIN 11 TEETH (FRONT)
866-31697 6" FRONT END ASSEMBLY W/TREADS W/O ACCESSORY KIT
866-30378 ASSEMBLY TREAD DRIVE COMPLETE (1 PER SIDE)
867-30584 ASSEMBLY CHAIN TREAD DRIVE #35 CHAIN W/ 41 PADS
(1 PER SIDE)

8" CRAWLER TRACK DRIVE REPLACEMENT PARTS

401-12771 POP RIVET .125" DIAMETER / .188" - .250" LENGTH SS
404-13120 BALL BEARING 1.125OD,.500 BORE,.312 WIDE DOUBLED SEALED
449-24013 CHAIN GUIDE RAILS (NOTE: 2 REQUIRED PER SIDE), EACH
449-30327 BRIDLE CLAMPS
451-30611 REPLACEMENT PADS (DRILLED, SINGLE OR DUAL RIVET, EACH
805-31508 IDLER SPROCKET #40 CHAIN 12 TEETH (FRONT)
805-24114-40 DRIVE SPROCKET #40 CHAIN 12 TEETH (REAR)
866-31900 8" FRONT END ASSEMBLY W/TREADS
866-31667 ASSEMBLY TREAD DRIVE COMPLETE (1 PER SIDE)
867-24026 TREAD DRIVE CHAIN ASSEMBLY # 40 CHAIN, 36 PADS

STEERABLE STORM DRAIN (LARGE LINE) TRACTOR PARTS

301-15193	FRONT BUMPER MTG BOLTS
541-20296	LAMP, REPLACEMENT FOR WATERTIGHT LIGHT
803-17819-21	ASSY, FRONT BUMPER
807-17895-21	LEFT ELEVATOR SKID ASSY
807-17894-21	RIGHT ELEVATOR SKID ASSY
840-17645	CAMERA MOUNTING KIT OEIII
867-14840	ASSY, LIFTING BRACKET (REAR BUMPER)
867-17906	ASSY, WHEEL, 11"X4", GSDT
860-34060	HI-TRACTION TIRES 13"x 5"x 6", R-1 DESIGN, EA.

NOTE: REQUIRES SPACERS TO BE INSTALLED ON FRONT BUMPER ASSEMBLY

LARGE LINE LIGHTS PARTS & ACCESSORIES

541-10090	LAMPS FOR LARGE LINE LIGHTS, 65W 12V
549-12401	WINDOW FOR LARGE LINE LIGHT, 2" x 1/4" THICK, QUARTZ
840-15426	KIT, O-RING, LARGE LINE LIGHT HEAD
861-18596	ASSY, PCB, CONSTANT CURRENT SOURCE W/O C2

CABLE

569-19107	SINGLE CONDUCTOR, KEVLAR ARMORED, PER FOOT
569-20283	SINGLE CONDUCTOR, STEEL ARMORED, PER FOOT
569-20686	MULTI-CONDUCTOR, PER FOOT

3-PIN FEMALE PUSH-ON, TERMINATED

806-15188	ASSY, SINCON, 2000' - TERMINATED (SPECIAL ORDER)
806-15011	ASSY, SINCON, 1500' - TERMINATED (SPECIAL ORDER)
806-14778	ASSY, SINCON, 1000' - TERMINATED (SPECIAL ORDER)
806-10291	ASSY, SINCON, 500' - TERMINATED (SPECIAL ORDER)

3-PIN (BULLET) SCREW-ON W/ 3 CONDUCTOR CONNECTOR

806-31523	ASSY, SINCON, 2000' - TERMINATED (SPECIAL ORDER)
806-31522	ASSY, SINCON, 1500' - TERMINATED (SPECIAL ORDER)
806-31521	ASSY, SINCON, 1000' - TERMINATED (SPECIAL ORDER)
806-31520	ASSY, SINCON, 500' - TERMINATED (SPECIAL ORDER)

EXPLOSION PROOF TERMINATED

806-32386	ASSY, SINCON, 2000' -TERMINATED (SPECIAL ORDER)
806-33967	ASSY, SINCON, 1500' - TERMINATED (SPECIAL ORDER)
806-33267	ASSY, SINCON, 1000' - TERMINATED (SPECIAL ORDER)

PUSH CABLE ASSEMBLIES, TERMINATED

806-10469	ASSY, CBL, PUSH 150', TERMINATED
806-20807	ASSY, CBL, PUSH 200', TERMINATED
806-20530	ASSY, CBL, PUSH 250', TERMINATED
806-20531	ASSY, CBL, PUSH 300', TERMINATED

AIRCRAFT CABLE, PER FOOT

569-13266	CBL, AIRCRAFT, 1/8", 7/19 STRND, SS, PER FOOT
569-13380	CBL, AIRCRAFT, 1/8", 1000'
569-13494	CBL, AIRCRAFT, 3/16", 7/19 STRND, SS, PER FOOT
569-18971	CBL, AIRCRAFT, 3/16", 500'

IN-LINE SONDE TRANSMITTERS

806-31769 ASSY, CBL, SONDE 3-PIN TO 6-PIN
841-30268 FACTORY UPGRADE SONDE KIT
841-33232 KIT, FIELD TERMINATION, SPRING COUPLER W/SONDE

CABLE REEL PARTS AND CABLE ASSYS

COMPACT PORTABLE REEL MECHANICAL REPLACEMENT PARTS

407-17328 SHAFT, WHEEL, COUNTER, ENGLISH, CPR
407-15913 PAWL, LEVEL WIND FOLLOWER
407-19728 SHAFT, LEVEL WIND, 10" REEL, CPR
443-10485 WHEEL, SEMI-PNEUMATIC, 8 X 2.50, 5/8"AXL
443-13810 WHEEL, SENSOR, FOOTAGE COUNTER
443-19707 ROLLER, GUIDE, TOP, 1.5", MML
446-14157 SPRING, WHEEL TENSION, FOOTAGE COUNTER
449-15325 ROLLER, GUIDE, POLYURETHANE
451-19723 BLOCK, FOLLOWER, CPR
451-19761 BRKT, DRAG CLUTCH, CPR
452-19758 BOX, JUNCTION, CAMERA PWR & FTG, CPR
635-14080 MOTOR, 1/2 HP, POR/CPR
805-31064 ASSY, CLUTCH, CPR
867-13456 COUNTER, MECHANICAL, 5 DIGIT, 10CTS
867-19495 ASSY, COUNTER, FTG, CPR

COMPACT PORTABLE CABLE REEL ELECTRICAL REPLACEMENT PARTS

555-13488 CONN, N, JACK, SQ FLANGE MT, SOLDER CUP
556-10977 JACK, 4PIN, PANEL MT, (FOOTAGE CONNECTOR)
560-17861 CONN, SLIP RING, RCPT, 3COND, COAX, 3-6" LEADS
560-17862 SLIP RING, 3 CONDUCTOR, COAX
806-18586 ASSY, HARNESS, FOOTAGE ENCODER, W/CABLE, W/BRKT
863-20537 ASSY, CNTRLR, SPEED, MOTOR, 120VAC, CPR

PUSH REEL REPLACEMENT PARTS (STANDARD PUSH REEL, ONLY)

841-11650 RETERMINATION FOR PUSH CABLE 2X
806-11117 CABLE ASSEMBLY, CONTROLLER TO PUSH REEL SLIP RING

MAINLINE CABLE REEL REPLACEMENT MECHANICAL PARTS

404-14210 PINION BEARING
407-15913 FOLLOWER PAWL, LEVELWIND
407-12831 GUIDE ROLLER SHAFT
407-13465 LEVEL WIND SHAFT
407-15497 TORQUE ARM SHAFT
408-11721 SLIP RING COLLAR
441-11722 48-TOOTH SPROCKET (ON SINCON ROLLER WHEEL)
441-13239-30 168 TOOTH RING GEAR
443-13753-21 SINGLE CONDUCTOR COUNTER WHEEL
444-12255 HOOK, SNAP SWIVEL
444-11901 QUICK LINK
445-13183 TORQUE ARM ASSY
446-14273 FOLLOWER PAWL SPRING
446-14157 SPRING, WHEEL TENSION, FOOTAGE COUNTER
447-10545-31 CENTER SUPPORT BAR 17"
447-10663 KNOB, ALUM, MOTOR SPEED CONTROL
448-11253 CABLE GRIP ASSY W / SNAPHOOK & QUICKLINK
448-11312 MACHINED CABLE GRIP ONLY

448-11430	DRAG BRAKE FOLLOWER
448-11548	DRAG BRAKE PAD
449-15325	GUIDE ROLLER POLYURETHANE (V-GROOVE WHEEL)
451-10135-31	GUIDE ROLLER BRACKET (SLOTTED)
452-10316	DRIP PAN, 29"X40"X1", STAINLESS STEEL
543-10858	PINION ENGAGEMENT SOLENOID
805-11663	24-TOOTH SPROCKET (ON FOOTAGE COUNTER SHAFT)
805-14198	HIGH SPEED BENDIX ASSEMBLY (WITH 2 SPROCKETS)
805-14140	LOW SPEED BENDIX ASSEMBLY (WITH 1 SPROCKET)
805-19193-31	DRAG BRAKE FLANGE HOUSING ASSEMBLY
840-20802	FOOTAGE COUNTER CHAIN REPLACEMENT KIT
864-16909	FOLLOWER BLOCK ASSEMBLY WITH BRONZE BUSHING
867-13684	COMPLETE LEVEL WIND & COUNTER ASSEMBLY
867-20485	MECHANICAL FOOTAGE COUNTER, MAINLINE REEL
407-12367	SHAFT, FOOTAGE COUNTER
443-13810	FOOTAGE SENSOR WHEEL (DAISY WHEEL)
451-15091	FOOTAGE ENCODER BRACKET
452-11199-31	BOX, COUNTER HOUSING W/LID, BLUE
505-10486	SHAFT LOCK (FOR FOOTAGE SENSOR WHEEL)
505-19289	SHAFT LOCK BUSHING (FOR FOOTAGE SENSOR WHEEL)
800-21109	FOOTAGE COUNTER GUIDE ROLLER, ASSY, SS
805-21529	PINCH ROLLER ASSY
806-18586	ASSEMBLY FOOTAGE ENCODER HARNESS W/CABLE & BRKT
841-11414	REPAIR KIT, FOOTAGE ENCODER (DAISY WHL) KIT, TO INCLUDE: (1) SHAFT (1) WHEEL (1) CIRCUIT BOARD (1) SET BUSHINGS AND BEARINGS AS NEEDED

MAINLINE CABLE REEL ELECTRICAL PARTS

451-11315	BRACKET, LIMIT SWITCH
503-12789	RES, VAR, 2W, 10% 10K (MOTOR SPEED CONTROL)
529-11682	FUSE, 10-AMP, MOTOR CONTROL BOARD
529-10384	CIRCUIT BREAKER, 12A,
529-10502	CIRCUIT BREAKER, 3A, ½ MTG HOLE
542-12389	LIMIT SWITCH
542-14639	SWITCH, TOGGLE, SPST, IN / OUT CONTROL
542-14233	SWITCH, TOGGLE, SPDT, CENTER OFF, HIGH-LOW
542-14291	SWITCH, TOGGLE, SPDT MOMENTARY, ON / OFF
543-15755	RELAY, 120V (3 REQUIRED)
543-10209	RELAY, 48V (2 REQUIRED)
557-13260	3-PIN PIGTAIL, FEMALE 1EA (M/L REEL)
560-11746	SLIP RING CONNECTOR (TWO 6" LEADS)
560-11687	SLIP RING CAP (2 SOLDER TABS)
560-11628	SLIP RING, MERCURY WETTED, SEALED (2 CONDUCTOR)
560-17862	SLIP RING, MERCURY WETTED, SEALED (3 CONDUCTOR)
560-17861	SLIP RING CONNECTOR (THREE 6" LEADS)
560-17860	SLIP RING CAP (3 SOLDER TABS)
560-34363	SLIP RING, MERCURY WETTED, SEALED (4 CONDUCTOR)
560-11569	SLIP RING, MERCURY WETTED, SEALED (6 CONDUCTOR)
560-21904	SLIP RING, MERCURY WETTED, SEALED (8 CONDUCTOR)
635-13163	MOTOR, ¾ HP, 90V
806-18586	ASSY, HARNESS, FOOTAGE ENCODER
863-10905	CONTROLLER, MOTOR SPEED

REMOTE POWER WINCH II REPLACEMENT PARTS

407-15913 FOLLOWER PAWL, LEVELWIND
407-16120 LEVEL WIND SHAFT
400-16124 CLEVIS PIN
441-16118 LEVEL WIND DRIVE SPROCKET
443-16123 LEVEL WIND GUIDE ROLLER
443-16141 WHEEL, SEMI-PNEUMATIC, 12 X 3, 3/4" AXLE
449-15325 ROLLER
451-16121 LEVEL WIND MOUNTING BLOCK
800-16127 LEVEL WIND TORQUE ARM ASSEMBLY
805-16078 DRIVE MOTOR ASSEMBLY
806-15129 14-3 POWER CORD, 20FT

POWER WINCH 1 (REPLACEMENT PARTS ONLY)

444-12255 SWIVEL SNAP HOOK
444-11901 QUICK LINK
635-14080 DRIVE MOTOR
443-10485 WHEEL, SEMI-PNEUMATIC, 8 X 2.50, 5/8" AXLE

DOWNHOLE ROLLER REPLACEMENT PARTS

449-15325 REPLACEMENT GUIDE ROLLER (V-GROOVE WHEEL)
805-12527 DRAG BRAKE SHAFT HANDLE ON MANHOLE ASSEMBLY
405-15873-31 SLEEVE, INTERLOCKING
410-13006 SNAP RINGS, 5/8" (FOR ROLLER SHAFT)
300-12361 1/4-20X3" HEX BOLT & NUT (DOWNHOLE ROLLERS)
447-15944 SNAP BUTTON LATCH
446-16853 SPRING

ARTICULATING ARM REPLACEMENT PARTS

400-20659 PIN, SPRING-STYLE, 3/8" > 3/4", .093 WIRE
400-20660 PIN, CLEVIS, .5" DIA X 2.75" L STEEL
400-32402 PIN, QUICK RELEASE, SELF LOCK W/LANYARD
440-32401 PULLEY, IDLER, V-BELT
447-10073 KNOB, CAST IRON, 3/8-16, 2.0DIA, 1.12H, CAD PLATED
453-30498 PLATE, SIDE, GUIDE ROLLER, ARTICULATING ARM

INVESTIGATOR CAMERA SYSTEM

443-32561 WHEELS
455-30266 BOOT CONNECTION PROTECTOR
455-32296 FIBERGLASS EXTENSION POLE
548-30699 BATTERY PACK, WAIST MOUNTED W/CHARGER
548-30699-1 CHARGER, BATTERY REPLACEMENT, BESCOR ATM-PRB
806-32568-01 INTERCONNECT CABLE, 30', CONTROLLER TO CAMERA
863-31371 HAND HELD AUXILIARY CONTROLLER
867-33327 ASSY, INTERFACE, POLECAM SYSTEM TO MAINLINE SYSTEM
867-33303 STEADY REST ASSY, 32"
888-32980 ASSY, CABLE, POLE CAM TO SINCON CABLE

*EQUIPMENT PICTURES
WITH MOST FREQUENTLY
ORDERED PART NUMBERS
BY PRODUCT*

LAMP SOCKET & REFLECTOR
ASSEMBLY #802-11470

TOP HEAD SKID
#450-14449

LAMP, HALOGEN
#541-30962 ZOOM/LISTED ONLY
#541-10326 NON-ZOOM
#541-21295 ZOOM/NON-LISTED

LENS AND LAMP
WINDOW KIT
#840-13442

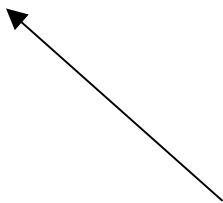

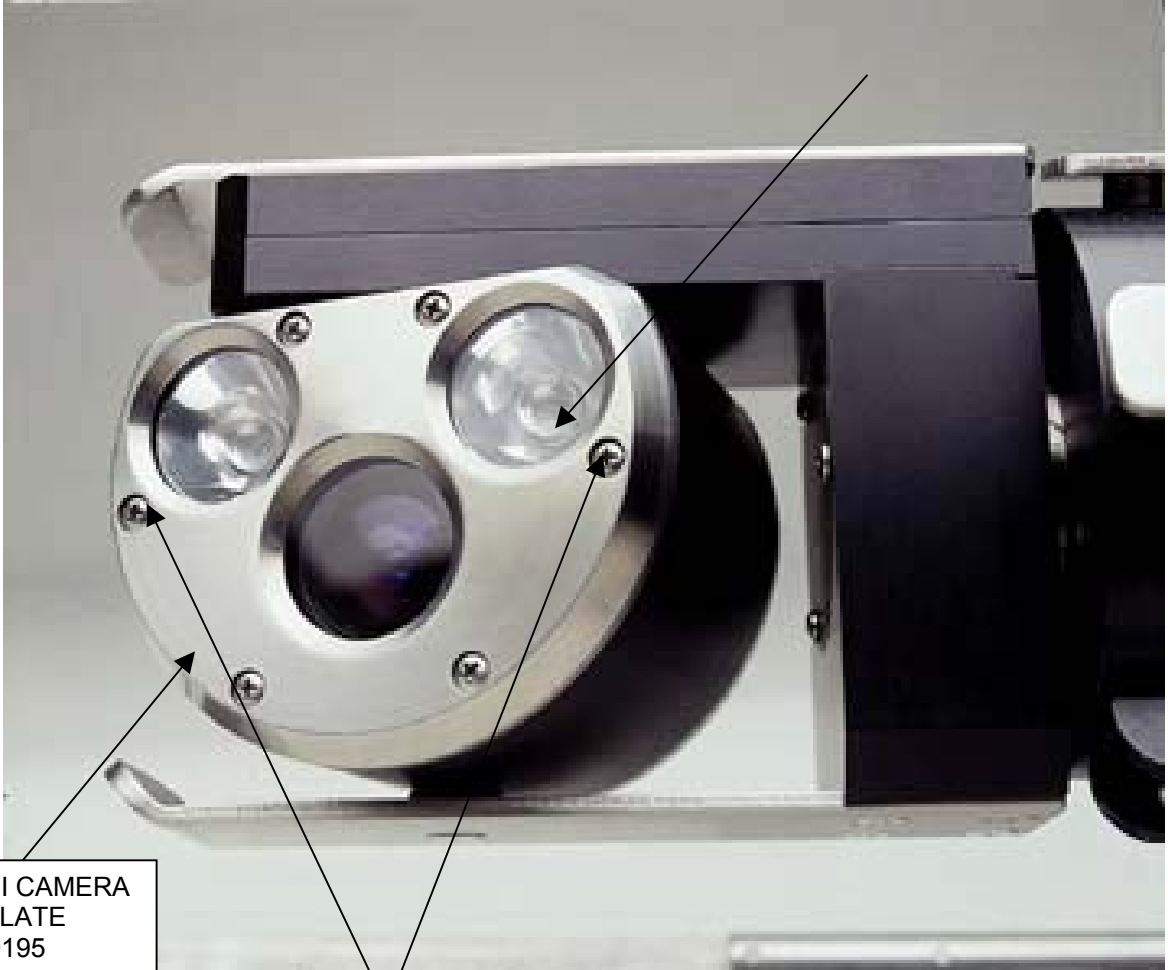

OE II / III CAMERA
FACE PLATE
#451-10195

SCREWS, FACE PLATE, OE
II / III CAMERA #301-11181
(6 REQUIRED)

BOTTOM HEAD SKID
#450-14391

**RST OMNI-EYE SERIES CAMERAS ARE LISTED AND
CERTIFIED AS SAFE FOR USE IN A WET ENVIRONMENT
(SEE METAL TAG ATTACHED TO CAMERA)**

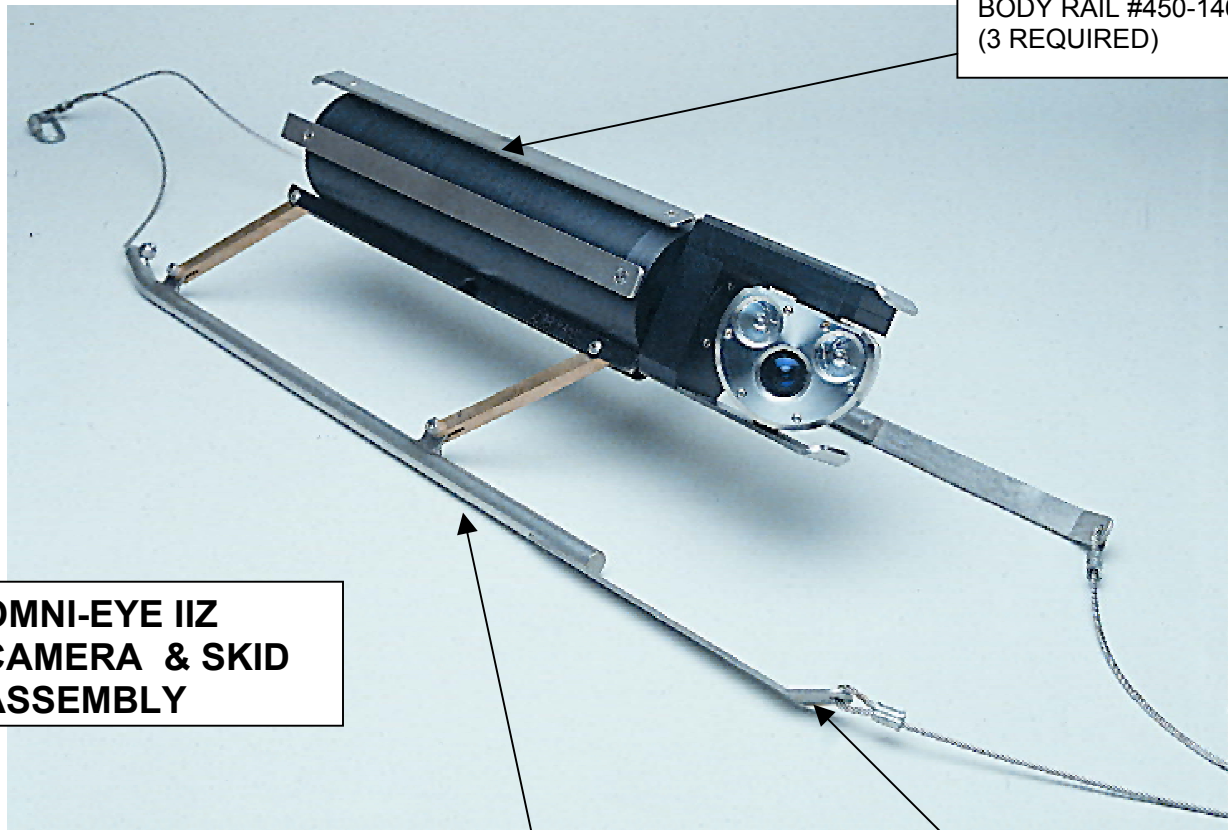

BODY RAIL #450-14683
(3 REQUIRED)

**OMNI-EYE IIZ
CAMERA & SKID
ASSEMBLY**

SKID ASSY, ADJUSTABLE,
FOR 6" - 16" PIPE #807-17784

SKID RUNNER
EXTENSION
#450-10134
SKID RUNNER
EXTENSION W/BRIDLE
#450-14159

OEII PARTS

- | | |
|-----------|--|
| 301-11181 | 4-40 x .31" PANHEAD SCREW (RETAINER WINDOW SCREWS (6 REQUIRED) |
| 301-11713 | 4-40 x .37" SOCKET HEAD CAP SCREW (4 REQUIRED) |
| 301-15303 | 10-32 x .625" FLATHEAD PHH SCREW SS UNDERCUT (2 REQUIRED) |
| 301-13172 | 10-32 x .375" FLATHEAD PHH SCREW SS UNDERCUT (4 REQUIRED) |
| 301-13515 | 8-32 x .50" FLATHEAD UC SS SCREW (4 REQUIRED) |
| 305-10241 | 10-32 x 1.25" SEALING PAN PHH SS (CAMERA BODY BACKPLATE (2 REQUIRED) |
| 403-13419 | SPACER FOR MIDDLE BODY RAIL ON OEII |
| 439-13751 | O-RING, BUNA, 006 (6 REQUIRED) |
| 439-15321 | O-RING, SILICONE, 023 (LENS WINDOW) |
| 439-15557 | O-RING, SILICONE, 022 (LAMP WINDOWS) |
| 450-10134 | SKID RUNNER EXTENSION |
| 450-14391 | BOTTOM HEAD SKID |
| 450-14449 | TOP HEAD SKID |
| 450-14683 | BODY RAIL (3 REQUIRED) |
| 451-10195 | FACE PLATE |
| 541-10326 | LAMP, HALOGEN, 14V, 25W, #790 (OEII/III) NON-ZOOM CAMERAS ONLY |
| 541-30962 | LAMP, HALOGEN, 12V, 20W (OEII/III) LISTED ZOOM CAMERAS ONLY |
| 560-15227 | PIGTAIL PLUG PROTECTOR (3 PIN PUSH-ON STYLE BHC) |
| 800-17767 | CAMERA TRACTOR CRADLE |
| 802-11470 | ASSY, LAMP SOCKET & REFLECTOR |

- 806-31431 ASSY, HARNESS, 6PIN MALE BULKHEAD CONN-3PIN WALDOM (BULKHEAD CONNECTOR) (ML/OE1/OE2 ONLY)
- 807-17784 SKID ASSY, ADJUSTABLE 6" – 16" PIPE
- 840-11060 O-RING KIT FOR OEII
- 840-13442 WINDOW KIT (INCLUDES LENS WINDOW & TEFLON WASHER)
- 840-15131 HARDWARE KIT FOR OEII
- 840-15485 MAINTENANCE KIT
- 841-12063 10 PACK OF BULBS (OEII/III) NON-ZOOM CAMERAS ONLY
- 841-31900 10 PACK OF BULBS (OEII/III) LISTED ZOOM CAMERAS ONLY
- 867-12313 TOW BRIDLE 18" FOR REPLACEMENT ON SKID ASSY

OMNI-EYE II CAMERA BULB REPLACEMENT

INSTRUCTIONS

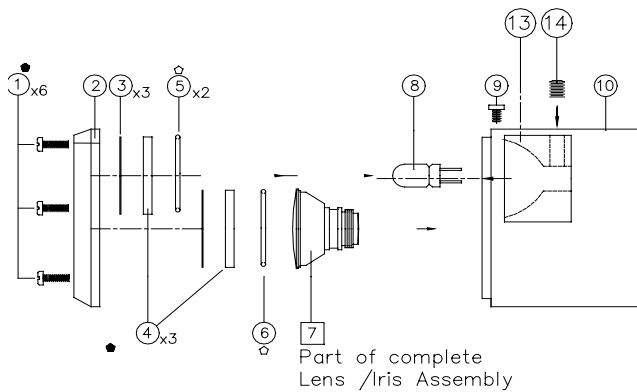
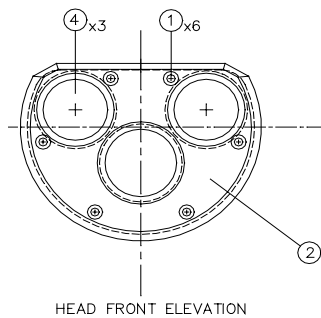

BILL OF MATERIALS			
Item	Part No.	D E S C R I P T I O N	Qty.
1	301-11122	4-40 x 3/8" PAN HEAD SCREW	6
2	461-10195	WINDOW HEAD RETAINER	1
3	317-17066	TEFLON WASHERS, On front of windows.	3
4	317-17066	WINDOW 1.188 X 0.125 QUARTZ (ZOOM 549-17208 sapphire 1.188od x 125t)	3
5	439-15557	O-RING, Size 22, Silicon, Light Windows	2
6	439-15321	O-RING, Size 23, Silicon Lens Window	1
7			1
8	541-10326	LAMP, Halogen, 14v, 25W, #790 (ZOOM LAMP Halogen 541-30962 12v 20w)	2
9			1
10	454-10078	CAMERA HEAD (ZOOM 454-30438-21)	1
11			1
12			1
13	802-11470	LAMP REFLECTOR (ZOOM 802-30964)	2

OEIII PARTS & ACCESSORIES

301-11181 4-40 x .31 PANHEAD SCREW (RETAINER WINDOW SCREWS (6 REQUIRED))
301-13742 8-32 x .25" FLATHEAD SCREW UNDERCUT (OE3 BODY SKID, TO SKID BRKTS)
301-14203 8-32 x .625" PANHEAD SCREW (4 REQUIRED)
439-15321 O-RING, SILICONE, 023 (LENS WINDOW)
439-15557 O-RING, SILICONE, 022 (LAMP WINDOWS)
450-20329 TOP BODY SKID (REQUIRES SKID BRACKETS FOR INSTALLATION)
450-14391 BOTTOM HEAD SKID
450-14449 TOP HEAD SKID
451-10195 FACE PLATE
451-20335 TOP BODY SKID BRACKETS (2 REQUIRED)
541-30962 LAMP, HALOGEN, 12V, 20W (OEII/III) LISTED ZOOM CAMERAS ONLY
541-10326 LAMP, HALOGEN, 14V, 25W, #790 (OEII/III) NON-ZOOM CAMERA ONLY
800-21075 OEIII CRADLE
807-17784 SKID ASSY, ADJUSTABLE 6" – 16" PIPE
840-13442 WINDOW KIT (INCLUDES LENS WINDOW & TEFLON WASHER)
840-19920 MAINTENANCE KIT OEIII
841-12063 10 PACK OF BULBS (OEII/III) NON-ZOOM CAMERAS ONLY
841-31900 10 PACK OF BULBS (OEII/III) LISTED ZOOM CAMERAS ONLY
867-12313 TOW BRIDLE 18" FOR REPLACEMENT ON SKID ASSY

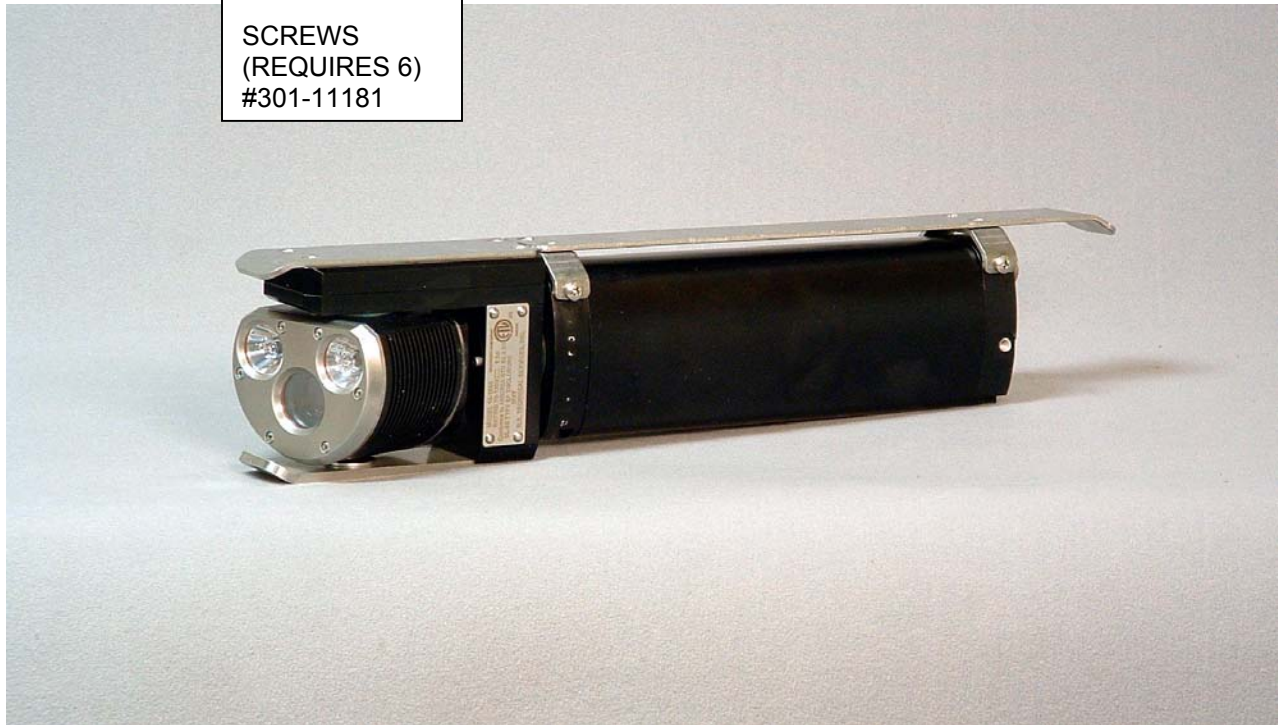
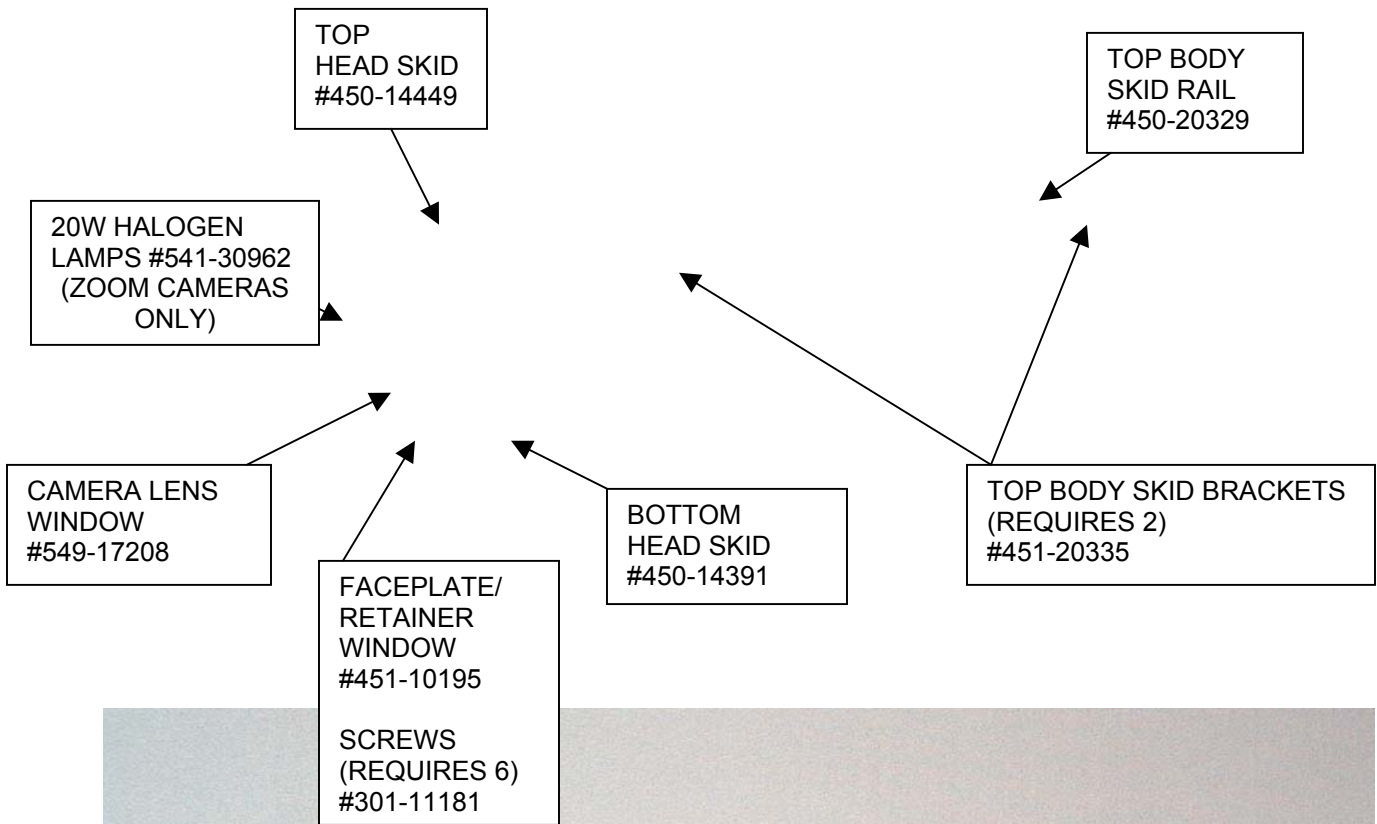

CAMERA WINDOW KIT INCLUDES
SAPPHIRE WINDOW & TEFLON
WASHER
#840-13442



NovaSTAR PARTS AND ACCESSORIES

301-11122	4-40 x .37 PANHEAD SCREW (RETAINER WINDOW SCREWS (6 REQUIRED)
301-13742	8-32 x .25" FLATHEAD SCREW UNDERCUT (OE3 BODY SKID, TO SKID BRKTS)
301-14203	8-32 x .625" PANHEAD SCREW (4 REQUIRED)
439-15321	O-RING, SILICONE, 022 (LENS WINDOW)
450-14159	ASSY, SKID EXTENSION W/BRIDLE ON SKID ASSEMBLY
450-20329	TOP BODY SKID (REQUIRES SKID BRACKETS FOR INSTALLATION)
450-33609-42	SKID, TOP, CAMERA HEAD, OMNI STAR
450-33612-42	SKID, LOWER HEAD, OMNI STAR
451-20335	TOP BODY SKID BRACKETS (2 REQUIRED)
451-34896-21	RETAINER, WINDOW, OMNI/NOVASTAR CAMERA
633-34827	TOOL, INSTALLATION, WINDOW RETAINER, OMNI STAR/ OMNI NOVA
800-21075	TRACTOR MOUNTING CRADLE
840-32306	SKID ASSY, ADJUSTABLE 6" – 16" PIPE
840-13442	WINDOW KIT (INCLUDES LENS WINDOW & TEFLON WASHER)
840-19920	MAINTENANCE KIT
867-12313	TOW BRIDLE 18" FOR REPLACEMENT ON SKID ASSY

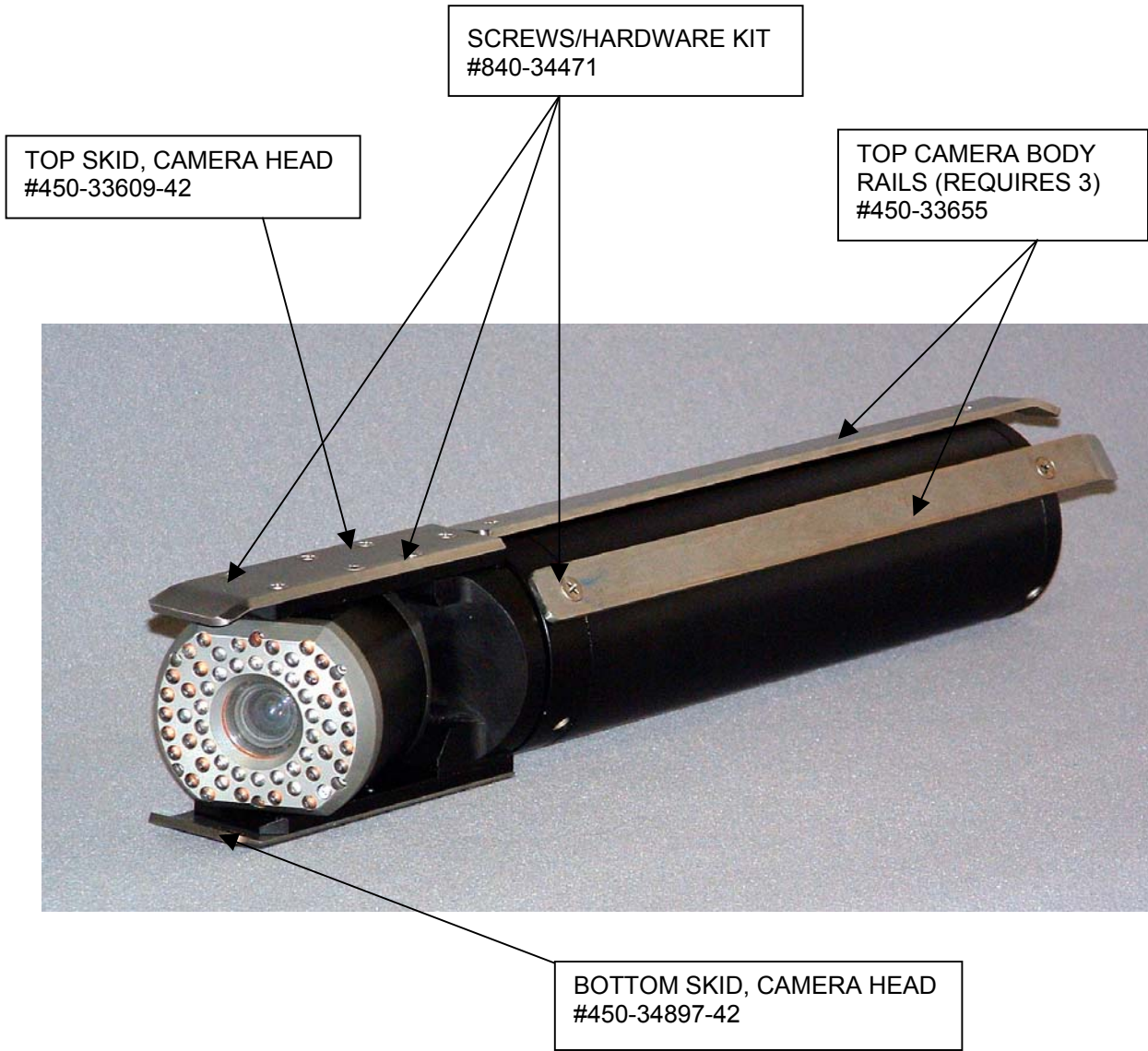

**OMNI STAR CAMERA
WITH ROTATING HEAD AND LONG LIFE
LED LIGHTS**

Standard Tractor Transporter Replacement Parts

805-17785	COMPLETE MOTOR ASSY, TYPE "A" VERSION
635-17887	GEAR MOTOR ONLY, DC, M/LTRACTOR
867-20813	ASSY, CLUTCH, REVERSING, M/L TRACTOR
867-14724	ASSY, CLUTCH, M/L TRACTOR
861-33241-2	ASSY, PCB, TRACTOR DUAL TONE DECODER/CONTROLLER
861-21321	ASSY, PCB, TRACTOR, RELAY/FILTER, 'A' MOTOR (LOCKED ROTOR)
861-14085	ASSY, PCB, TRACTOR POWER SUPPLY, M/L TRACTOR
802-31468	COMPLETE TRACTOR BACK ASSY, INCLUDING CIRCUIT BOARDS
802-31479	COMPLETE TRACTOR BACK ASSY, LESS CIRCUIT BOARDS INCLUDES: 6-PIN PREWIRED BULKHEAD CONN., TNC BHC, & AIR PRESSURE FITTING
453-13930-21	TRACTOR BACK PLATE, ANODIZED BARE
806-31465	BULKHEAD CONNECTOR, 6 PIN, PREWIRED, FOR TRACTOR ONLY
560-15227	PROTECTOR, BULKHEAD (SCREW ON STYLE)
555-11154	CONN, TNC, BULKHEAD, 1/2" MODIFIED (FOR TRACTOR BACK)
602-10512	FITTING, AIR PRESSURE, 1/4" MALE (ON TRACTOR BACK)
632-31479	INSULATOR, SHIELDED, DTMF /RELAY PCB, MLT

AXLES/GEAR ASSEMBLIES AND PARTS

840-21285	REBUILD KIT, TRACTOR BODY
805-19449	ASSY, AXLE, WHEEL DRIVE W/GEAR
840-31609	ASSY, AXLE, MAIN DRIVE W/3 GEARS
407-20405	AXLE, MAIN DRIVE, MLT, (AXLE ONLY)
407-20407	AXLE, WHEEL DRIVE, MLT (AXLE ONLY)
840-20808	KIT, GEAR, DOUBLE HUB, (INCLUDES PIN & CLIP)
840-20809	KIT, GEAR, SINGLE HUB, M/L TRACTOR, (INCLUDES PIN & CLIP)
439-10719	SEAL, TRACTOR AXLE
405-10658	BUSHING, TRACTOR AXLE, DELRIN (MUST BE REAMED AFTER INSTALLATION WITH A .379" REAMER – SEE 633-15420)
633-15420	REAMER, .379" FOR TRACTOR AXLE BUSHING
453-18594	BLOCK, FRONT & CRADLE MOUNT
606-13439	BLOCK, DRIVE SHAFT BEARING HARDWARE
840-11296	KIT, HARDWARE, M/L TRACTOR
840-30611	KIT, HARDWARE, TOP SKID AND CHANNEL, M/L TRACTOR
453-14164	COVER, GEAR, MAINLINE TRACTOR
439-10778	GASKET, TRACTOR TOP
630-12577	GREASE, SEMI-FLUID UTILITY TYPE 3 6OZ. JAR 15.00
630-15592	ADH, RTV, CLEAR, 2.8 OZ TUBE
451-15092	GREASE DAM
840-20821	KIT, REPAIR, GEAR COVER STANDOFF ML TRACTOR
400-10656	PIN, MOTOR MOUNTING

TRACTOR CRADLE ASSEMBLY

800-17767	CAMERA CRADLE ASSY. MAINLINE/OEII/OEII
800-21075	CAMERA CRADLE ASSY, OEIII & NOVASTAR
800-33353	CAMERA CRADLE ASSY, OE STAR
800-15305	RACK, STORAGE, TRACTOR

TRACTOR CRADLE PARTS

305-15315	BOLT, PIVOT, TRACTOR CRADLE
840-18252	KIT, UPGRADE, SS CRADLE FORK (2 FORKS)
450-17766	SKID RUNNER, TRACTOR CRADLE, 1/2"X1/2" DELRIN

451-17765 CRADLE FORKS, SQUARE TUBE OE2 (2 REQUIRED)
 453-30321-21 CENTER CRADLE PLATE
 453-14802-21 RIGHT SIDE CRADLE PLATE
 453-10965-21 LEFT SIDE CRADLE PLATE
 800-21074 CRADLE FORKS ASSY, OE3/NOVASTAR
 800-33352 CRADLE FORKS ASSY, OMNISTAR
 301-18563 MSCR, HEXHD, 1/4-20 x 1.50 (CENTER PLATE "JACK" BOLT)
 309-12653 NUT, HEX, 1/4-20 (CENTER PLATE "JACK" BOLT NUT)

TRACTOR RAILS & SKIDS

451-19072 TOP MOTOR RAIL
 451-14451 TOP BODY RAIL
 807-21024 TRACTOR BOTTOM SKID SET WITH BRIDLE **(REPLACES 450-13985)**
 450-19093 SKID, TRACTOR TOP **(REPLACES 450-10842)**
 410-19071-21 BULKHEAD PROTECTOR RING
 840-21023 BULKHEAD PROTECTOR RING KIT FOR MAINLINE TRACTOR TO INCLUDE:
 410-19071 RING PROTECTOR
 451-19072 TOP MOTOR RAIL
 450-19093 TOP TRACTOR SKID
 807-21024 BOTTOM SKID SET
 301-12707 8-32x3/8" FLT. HD SCREW (2)
 301-12359 8-32X1/2" FLT. HD SCREW (1)

Hardware Kit, Mainline Tractor

840-11296 HARDWARE KIT FOR MAINLINE TRACTOR TO INCLUDE:
 6 - 301-11653 MSCR, PAN, PHH, 6-32x1/4", SS (top plate cover)
 8 - 301-12707 MSCR, FLT, PHH, 8-32x.3/8", SS (center 2 holes top rail)
 2 - 304-18177 SSCR,HALFDOGPT, HXS, 10-32X.38SS
 (holds motor to brass, 2 bottom holes)
 2 - 301-12243 MSCR, FLT, PHH, 8-32x1",SS (front hole of the top rail)
 2 - 318-14730 WASHER, LKG, #8 INT. TOOTH SS (under 8-32X.37")
 2 - 309-12479 NUT, HEX, 8-32 SS
 (secures the 8-32X.37" screw with #8 washer)
 7 - 301-12359 MSCR, FLT, PHH, 8-32x1/2" SS (1back hole of the top rail)
 (2 skid bracket onto brass)(4 hold skids to tractor)
 14 - 301-13856 10-32 x 1-1/4" PHIL FLAT SS (side plates to bottom plate)
 6 - 301-13571 10-32 x 1" PHIL FLAT SS (4side plates to front plate)
 (2 side plates to dam)
 6 - 301-10651 1/4-20 x 1/2" SOCKET HEAD CAP SCREW SS
 6 - 304-10889 1/4-20 x 3/8" SET SCREW SS
 6 - 318-14614 WASHER, LKG, #8,INT TOOTH SS
 (under 6-32x.25 pans on cover)
 2 - 304-19876 SSCR, HALF DOG PT, HXS, 10-32X.25 SS
 (holds motor to brass, 2 top holes)

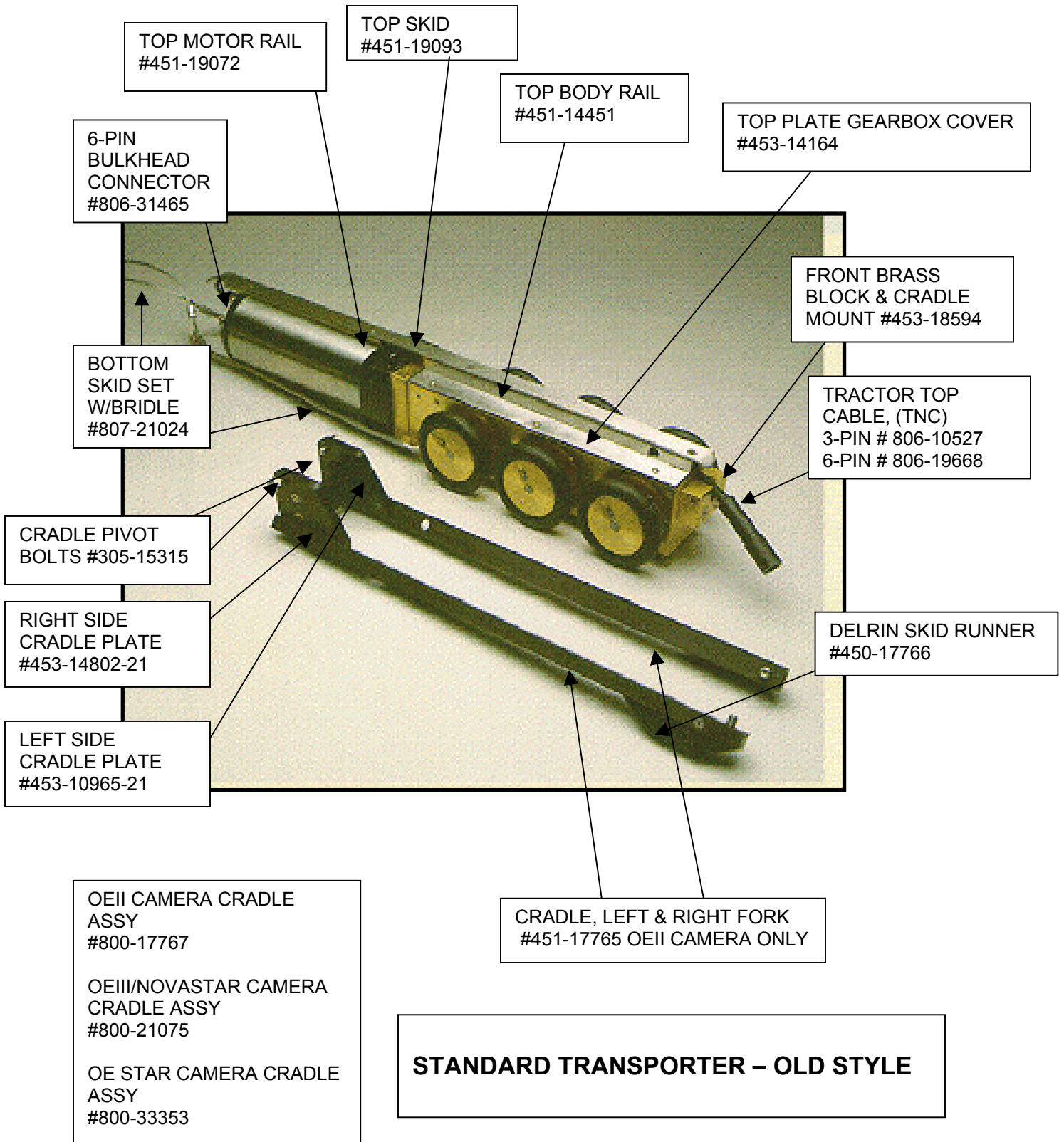

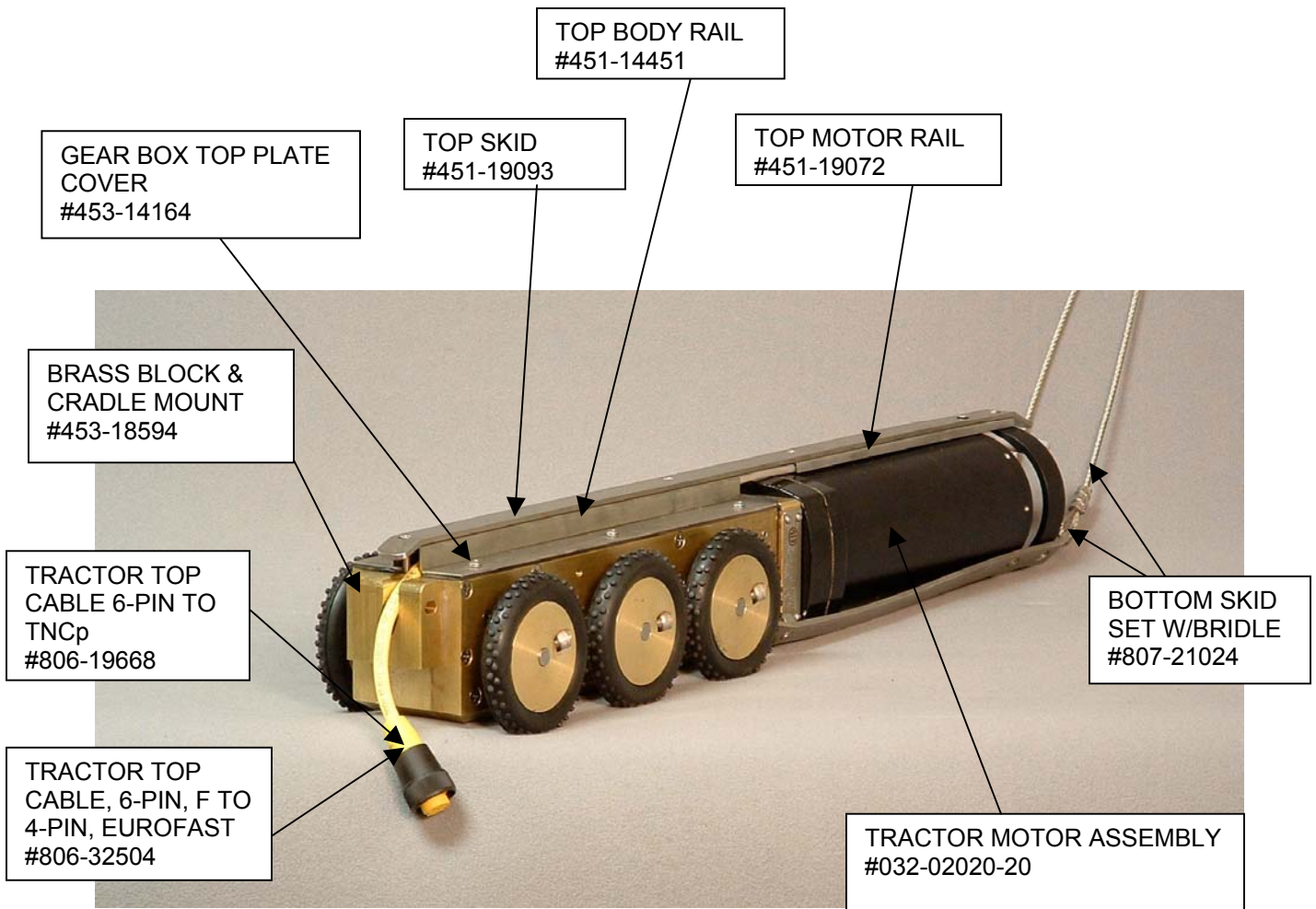

**STANDARD TRANSPORTER – LISTED AND CERTIFIED
SAFE FOR USE IN A WET ENVIRONMENT**

MAIN DRIVE AXLE W/3
GEARS
#840-31609

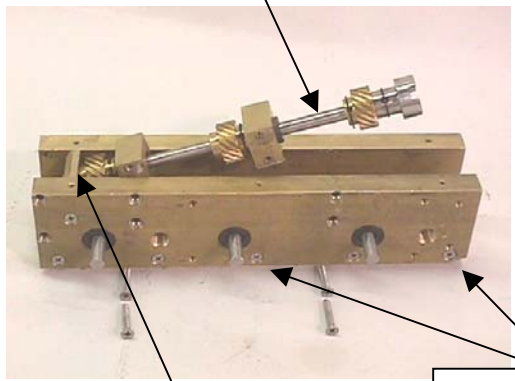

BRASS PLATE, RIGHT SIDE
#453-15624

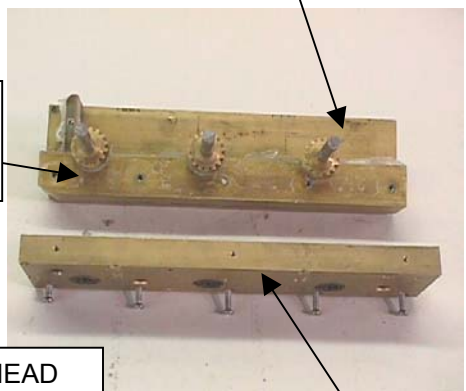

BRASS PLATE,
BOTTOM BASE
#453-15447

MSCR, FLAT, PHILLIPS HEAD
SCREWS, 10-32X.25 SS
#301-13856

GREASE DAM
#451-15092

BRASS PLATE, LEFT SIDE
#453-15565

MOUNTING BLOCK,
BEARING, DRIVE
AXLE
#606-13439

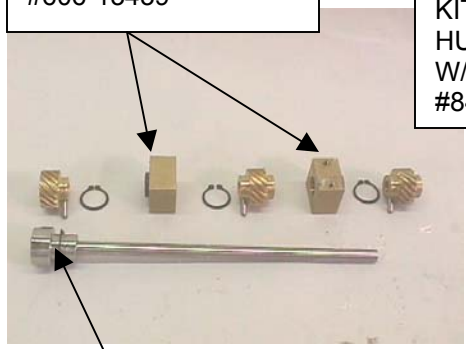

KIT, SINGLE
HUB, GEAR
W/PIN & CLIP
#840-20809

KIT, DOUBLE HUB
GEAR, W/PIN & CLIP
#840-20808

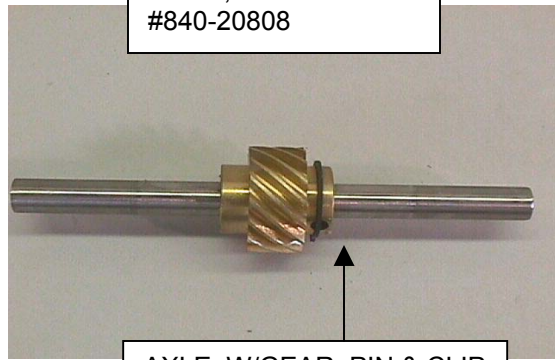

COUPLING CLUTCH,
FEMALE
#408-20423

AXLE, W/GEAR, PIN & CLIP
#805-19449

TRACTOR BODY
COMPLETE REBUILD KIT
#840-21285

REVERSING CLUTCH
ASSEMBLY
#867-20813

**STEERABLE STORM DRAIN TRANSPORTER
FOR LARGE LINE INSPECTION**

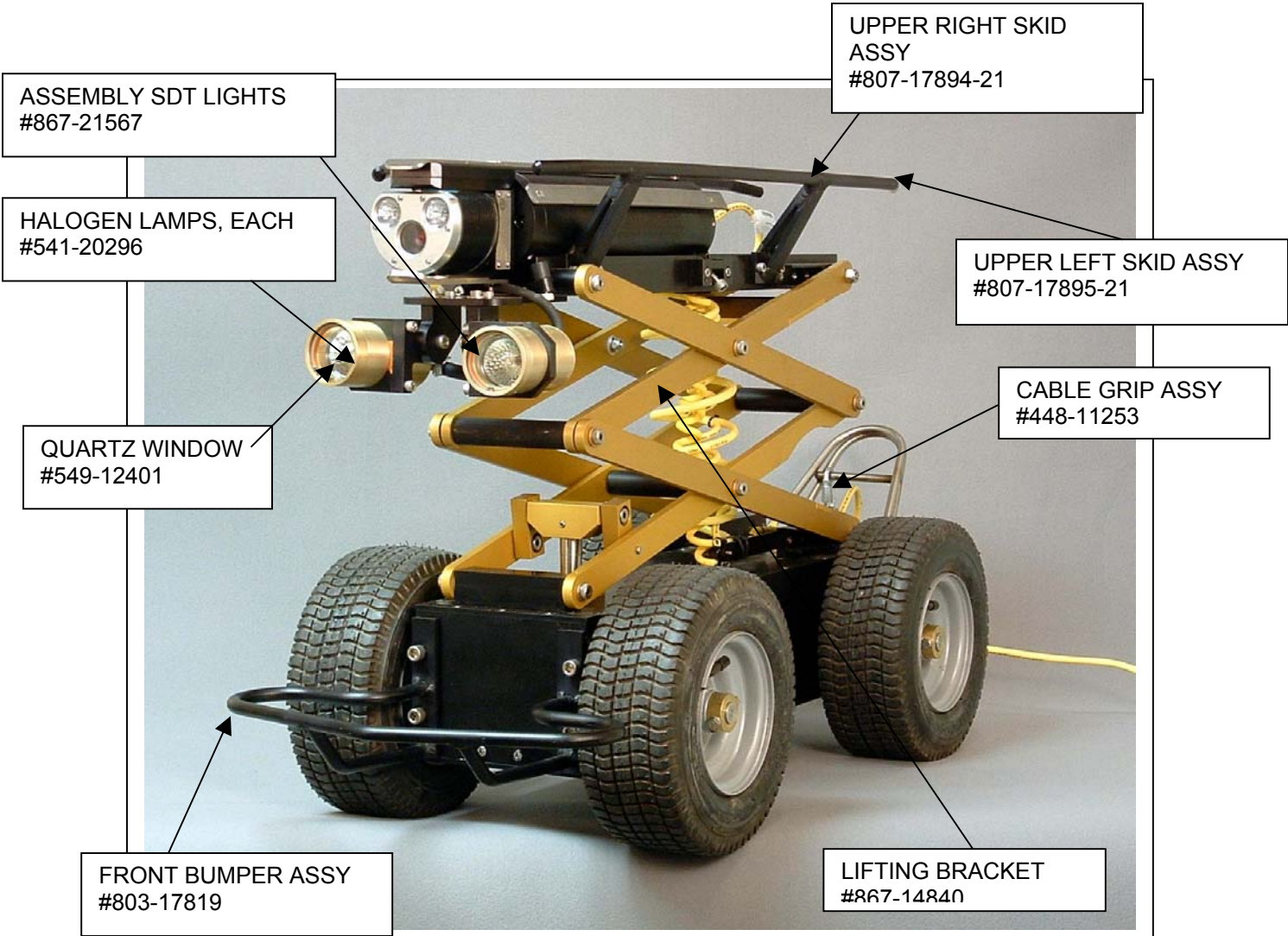

STEERABLE STORM DRAIN
TRACTOR, SINGLE CONDUCTOR
#036-02000-10

STEERABLE STORM DRAIN
TRACTOR, MULTI-CONDUCTOR
#036-02000-01

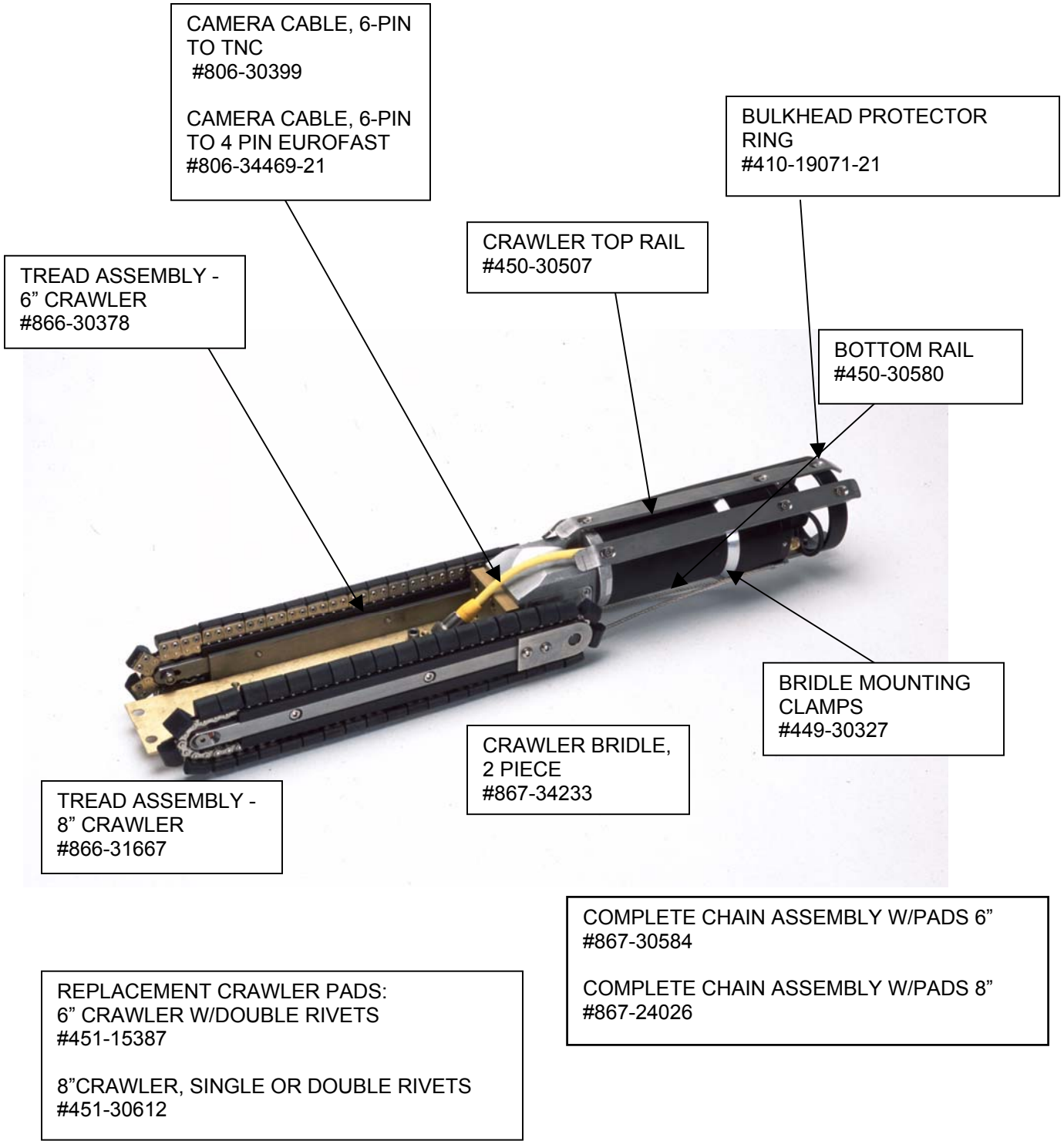

CAMERA CABLE, 6-PIN TO TNC
#806-30399

CAMERA CABLE, 6-PIN TO 4 PIN EUROFAST
#806-34469-21

BULKHEAD PROTECTOR RING
#410-19071-21

TREAD ASSEMBLY - 6\" CRAWLER
#866-30378

CRAWLER TOP RAIL
#450-30507

BOTTOM RAIL
#450-30580

BRIDLE MOUNTING CLAMPS
#449-30327

TREAD ASSEMBLY - 8\" CRAWLER
#866-31667

CRAWLER BRIDLE, 2 PIECE
#867-34233

COMPLETE CHAIN ASSEMBLY W/PADS 6\"
#867-30584

COMPLETE CHAIN ASSEMBLY W/PADS 8\"
#867-24026

REPLACEMENT CRAWLER PADS:
6\" CRAWLER W/DOUBLE RIVETS
#451-15387

8\" CRAWLER, SINGLE OR DOUBLE RIVETS
#451-30612

**CRAWLER – LISTED AND CERTIFIED
SAFE FOR USE IN A WET ENVIRONMENT**

**MAINLINE CABLE REEL,
STANDARD AND EXTRA-WIDE**

GUIDE ROLLER
BRACKET (REQUIRES 2)
#451-10135-31

POLYURETHANE
GUIDE ROLLER
#449-15325

LEVELWIND SHAFT
#407-13465

GUIDE ROLLER
SHAFT #407-12831

FOOTAGE COUNTER
ASSEMBLY
#867-13684

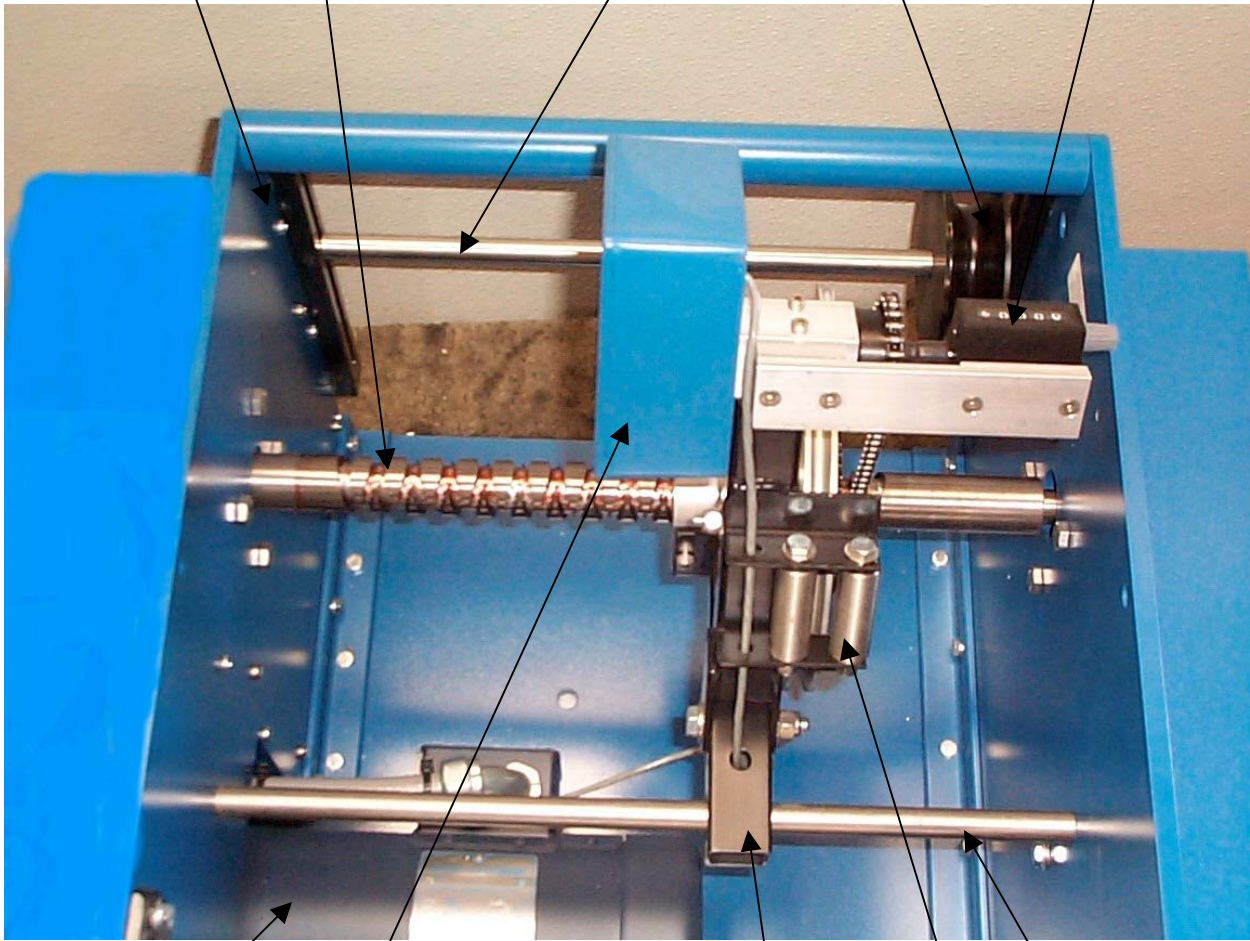

CABLE REEL
MOTOR
#635-13163

FOOTAGE COUNTER
BOX WITH LID
#452-11199-31

TORQUE ARM
ASSY
#445-13183

TORQUE ARM
BUSHING
#405-15319

TORQUE ARM
SHAFT
#407-15497

GUIDE ROLLER(S)
ASSY
#800-21109

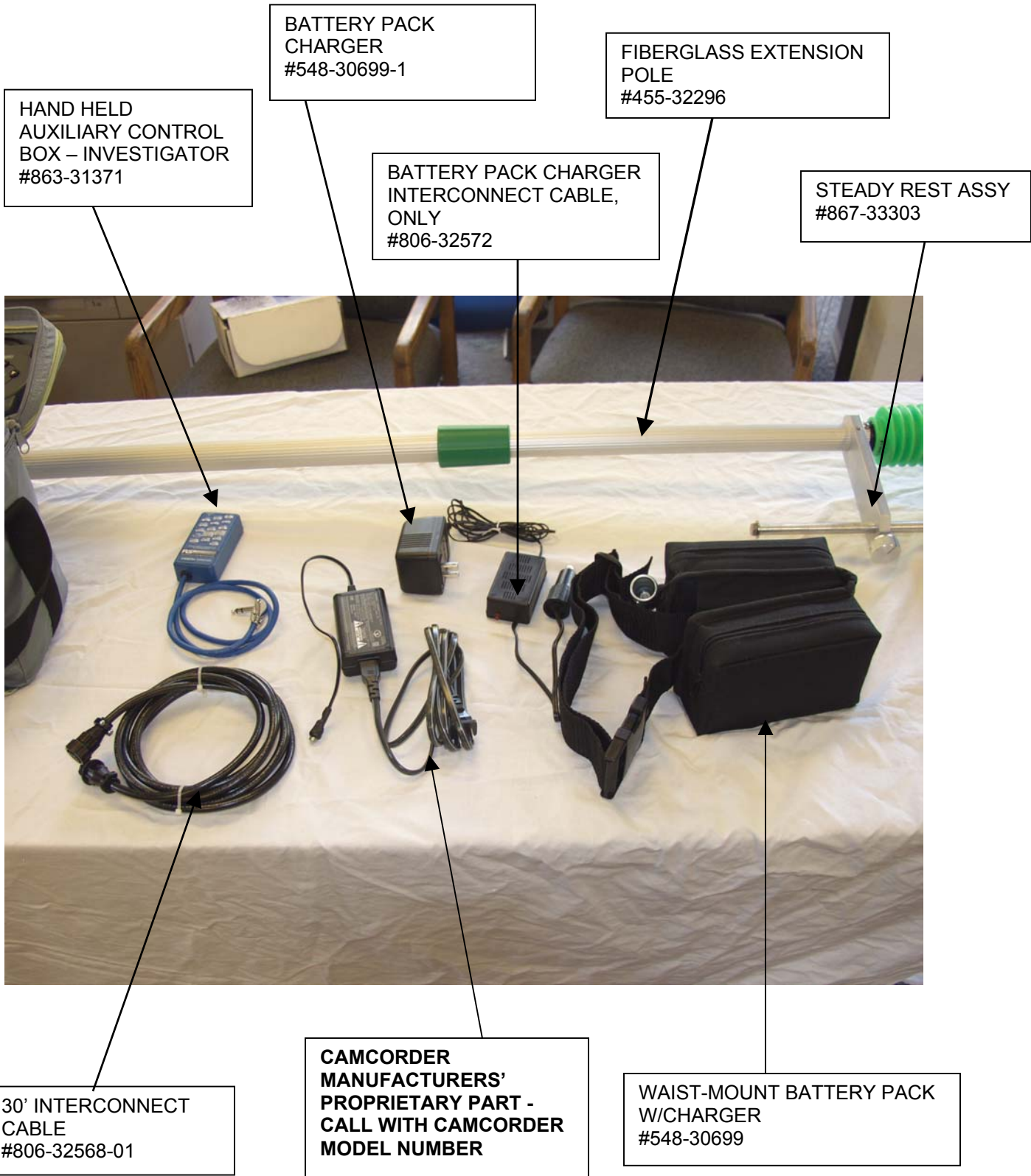

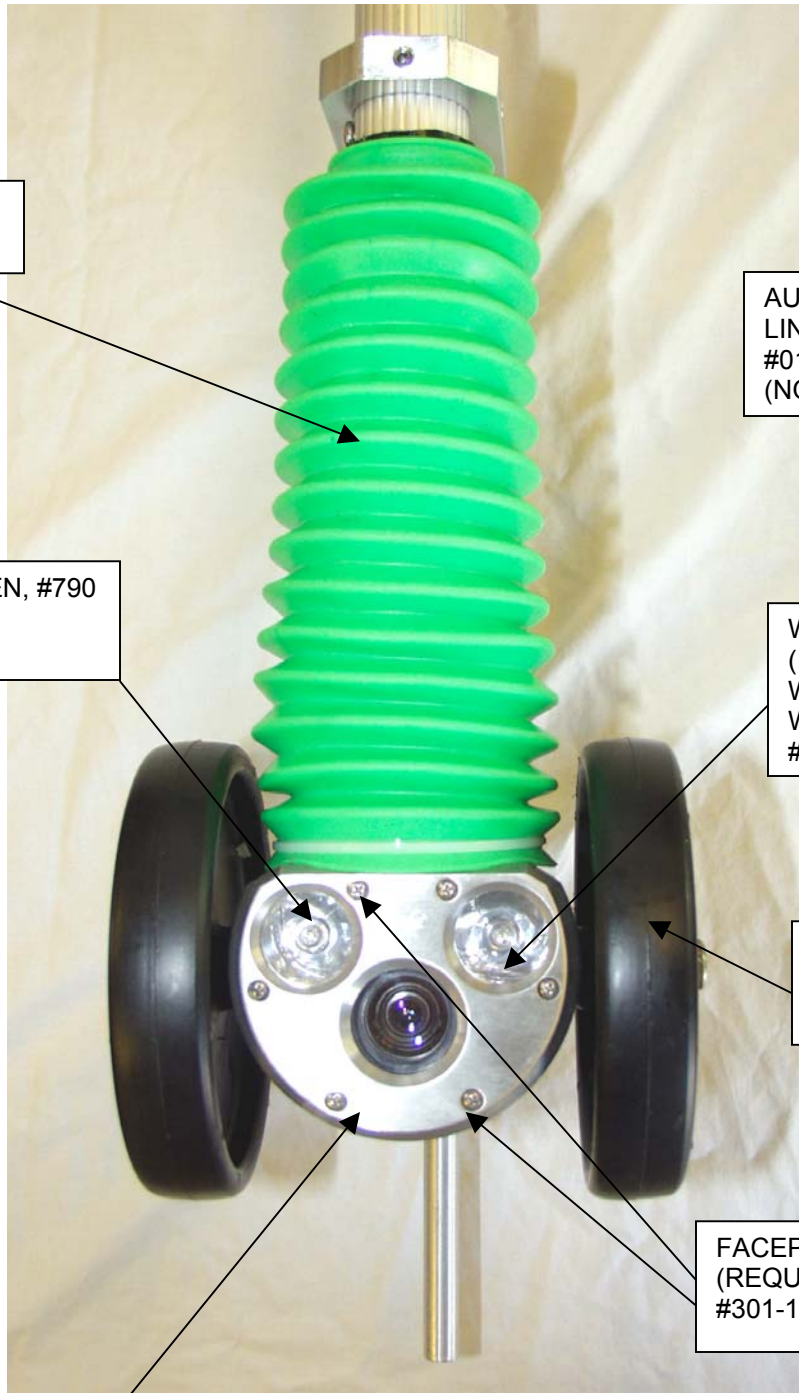

RUBBER BOOT
#455-30266

AUXILIARY LARGE
LINE SPOT LIGHT
#016-03010-01
(NOT SHOWN)

LAMP, HALOGEN, #790
12V, 20W
#541-30962

WINDOW KIT
(INCLUDES SAPPHIRE
WINDOW AND TEFLON
WASHER)
#840-13442

REMOVABLE WHEELS
(2 EACH)
#443-32561

FACEPLATE SCREWS
(REQUIRES 6)
#301-11181

FACE PLATE
#451-10195



TEST CABLE –
MAINLINE EQUIPMENT,
6-PIN N-PLUG TO TNCj
#806-31484

MINI CAMERA
EQUIPMENT, Np/TNCj
#705-14818



512 Hz SONDE
TRANSMITTER FOR
MAINLINE (OMNI-
SERIES) CAMERAS
#806-31769



15XX SERIES CAMERA
HEAD ONLY
#010-01530-01
#010-01535-01

123X/15XX SERIES ONLY
STANDARD MINI CAMERA
TAIL WITH PHENOLIC
BALLS
#867-19067





SPRING TAIL W/512 Hz
SONDE TRANSMITTER,
MINI CAMERA PUSH
REEL TERMINATION KIT
#841-33232



QUICK LINK 1/4 INCH
#444-11901

SNAP SWIVEL HOOK
#444-12255

SINCON CABLE GRIP
#448-11312

MSCR, SHCS, 10-32 X .75
#301-11477 (QTY 4)

SINCON CABLE GRIP ASSEMBLY
#448-11253



SKIDS, MINI CAMERA
4" – 8" 15XX SERIES
CAMERAS ONLY
#807-31965



LARGE LINE SKIDS,
OMNI-SERIES CAMERAS
ONLY
#807-17784



**KNOBBY BALLOON
WHEELS FOR 12" PIPE
AND LARGER
#867-21714**



**STANDARD WHEEL
W/KNOBBY TIRES FOR
6" – 8" PIPE SIZES
#443-10603**



**WIRE WHEELS FOR
8" – 16" PIPE SIZES
#443-15831**



**HI TRACTION WHEELS FOR
8" – 16" PIPES
#443-10190**